

AUTOMATIC SLACK ADJUSTER

ASA-5

CATALOG
05-A-22

The ASA-5, like other automatic slack adjusters, has been assigned an "AL Factor" of 195 which informs the user of proper brake chamber and ASA arm length.

The ASA-5 is unhandled with offsets provided by yokes instead of offset arms, and is available in 5, 5 1/2, and 6 inch arm lengths.

FOR SERVICE/MAINTENANCE INFORMATION, SEE SERVICE DATA SHEET SD-05-1269

WEIGHT - 7.5 lbs.

VMRS NO. - 013-001-030 (FRONT)

- 013-002-028 (REAR)

DEVICE CODE - 1269

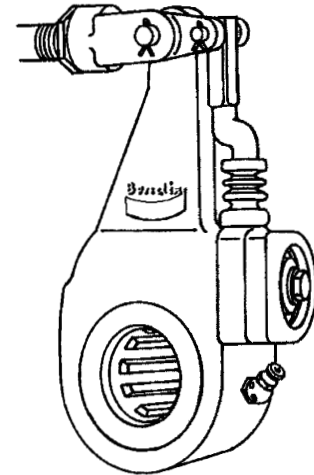

**ASA-5
EXTERIOR**

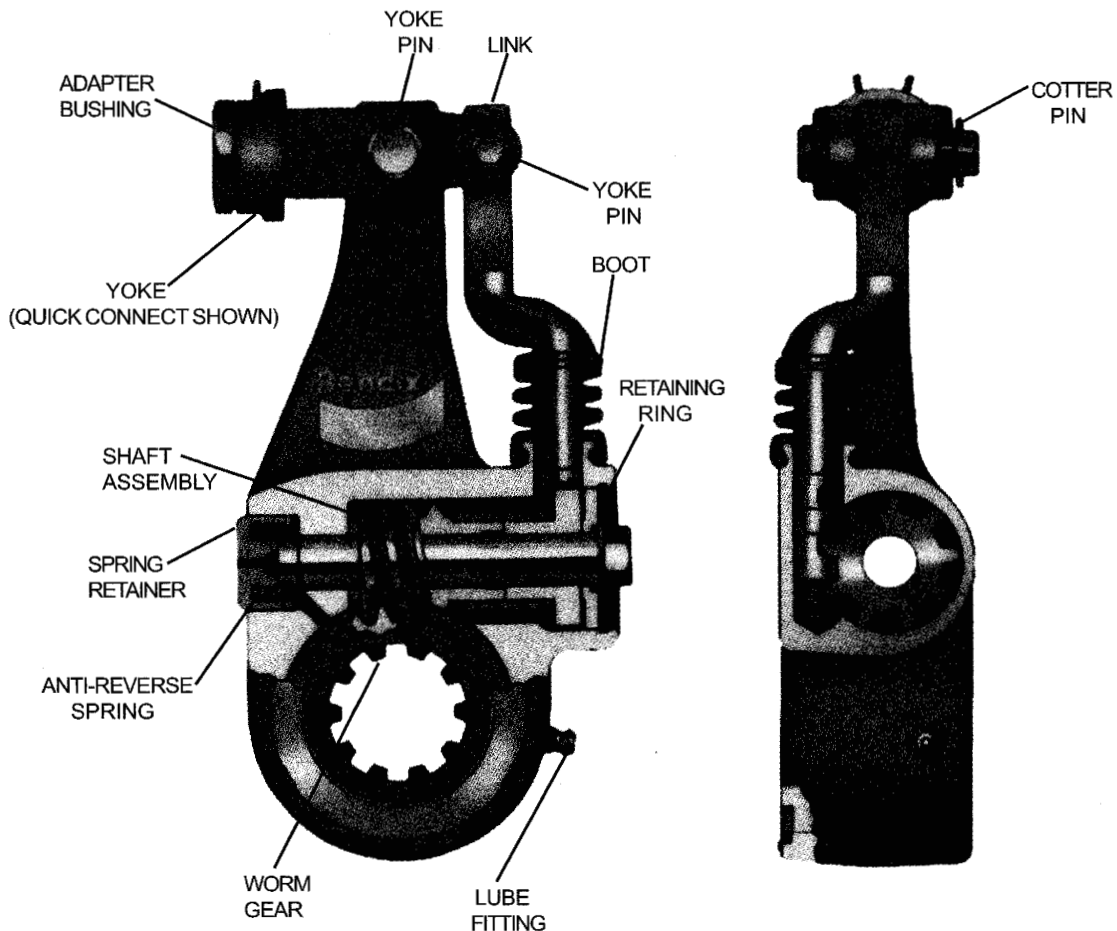

**ASA-5
SECTIONAL**

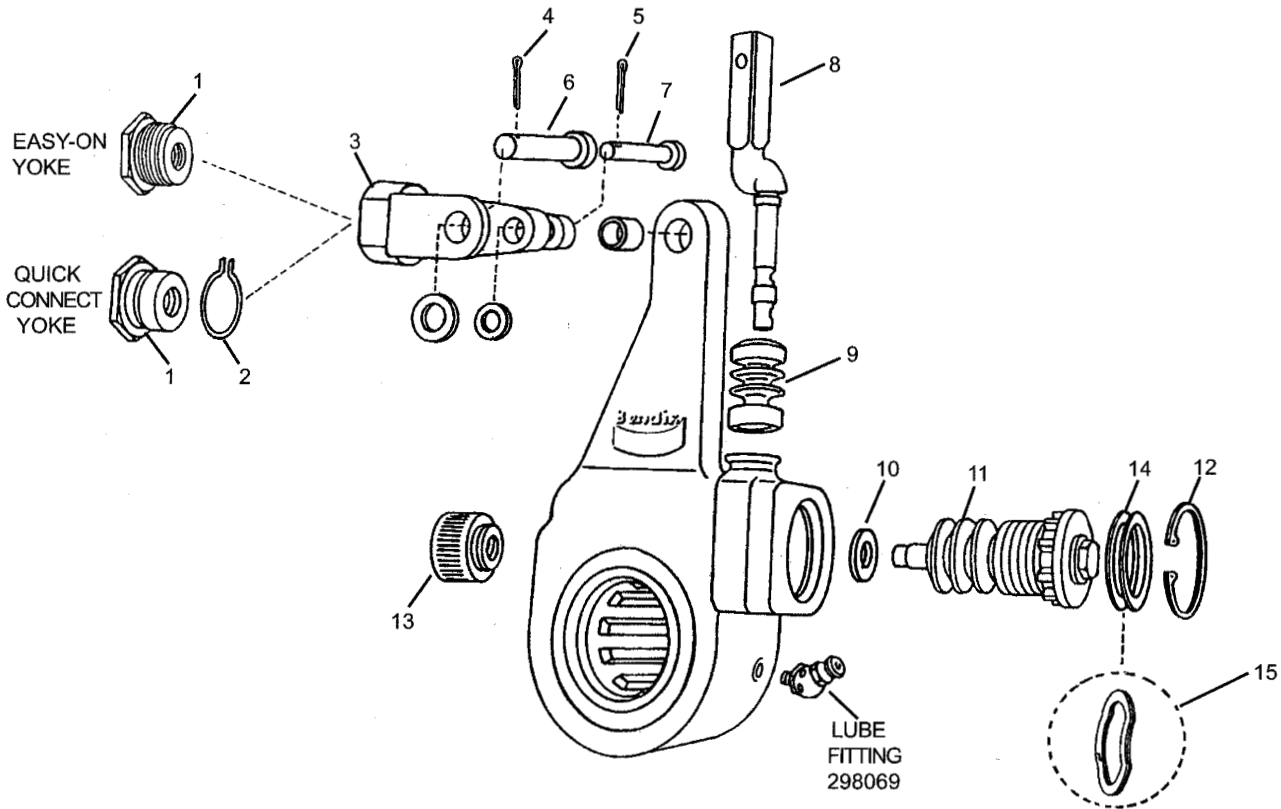

Quick Connect Adapter Kits

1/2" ADAPTER KIT 107162 AND 5/8" ADAPTER KIT 107161 CONSIST OF:

KEY NO.	QTY.	DESCRIPTION
1	1	ADAPTER BRUSHING
2	1	RETAINING RING

Adjuster Kit

ADJUSTER KIT 107156 CONSISTS OF:

KEY NO.	QTY.	DESCRIPTION
4	1	COTTER PIN
5	1	COTTER PIN
9	1	BOOT
10	1	THRUST WASHER
11	1	SHAFT ASSEMBLY
12	1	RETAINING RING
13	1	SPRING & RETAINER
14	4	SHIMS
15	1	WAVE RING

Link Kits

5" LINK KIT 107163, 5-1/2" LINK KIT 107164 AND 6" LINK KIT 107165 CONSIST OF:

KEY NO.	QTY.	DESCRIPTION
5	1	COTTER PIN
7	1	YOKE PIN
8	1	LINK
9	1	BOOT

Yoke Kits

Yoke kits are available in the following 4 configurations servicing the straight and offset yokes in both the quick connect and easy-on styles.

Straight Quick Connect Yoke Kit 107157

Offset Quick Connect Yoke Kit 107159

Straight Easy-On Yoke Kit 107158

Offset Easy-On Yoke Kit 107160

Each kit consists of the following:

KEY NO.	QTY.	DESCRIPTION
3	1	YOKE
4	1	COTTER PIN
5	1	COTTER PIN
6	1	YOKE PIN
7	1	YOKE PIN

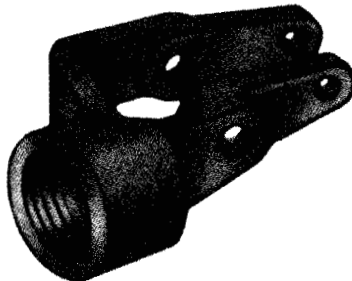

**EASY-ON
OFFSET YOKE
KIT 107160**

Easy-on yoke kits to be used with threaded adapters 291452, 292756, 297700, & 297701 only.

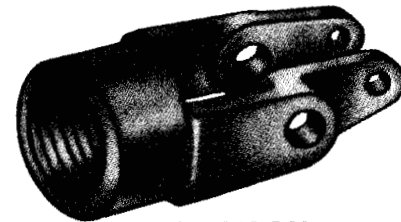

**EASY-ON
STRAIGHT YOKE
KIT 107158**

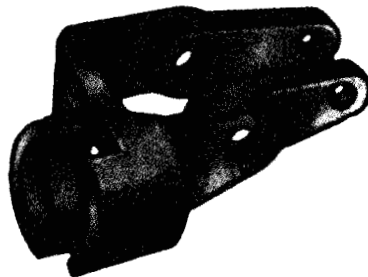

**QUICK CONNECT
OFFSET YOKE
KIT 107159**

Quick connect yoke kits to be used with adapter kits 107161 or 107162 only.

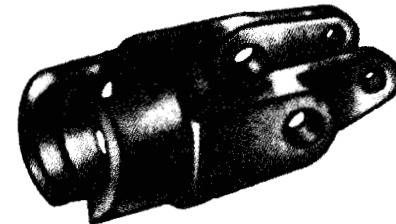

**QUICK CONNECT
STRAIGHT YOKE
KIT 107157**

Standard Adapter

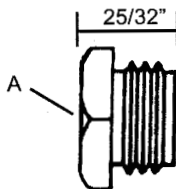

Yoke Adapter Pc. No.	A Push Rod Thread Size
291452	5/8"-18 UNF
292756	1/2"-20 UNF

Extended Adapter

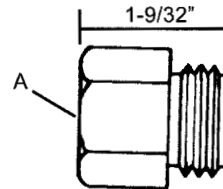

Yoke Adapter Pc. No.	A Push Rod Thread Size
297700	5/8"-18 UNF
297701	1/2"-20 UNF

ASA-5 Assy. Pc. No.	Service Replacement	Remanufactured Replacement
106199 106200 106904 106907 107119 107121 107123 107125 107266	065162	065550X
106197 106198 107113 107116 107267	065163	065551X
065165 106203 106206 107104 107107 107177 107263 107268 107477 107998 108644	065164	065557X
106903 106905 106906 106908 107120 107122 107124 107126 107269	065166	065552X
107246 107247 107256 107270 107420 107992 108646	065167	065558X
065275 106196 106901 107109 107111 107271 107907 108001	065168	065559X
106321 106322 107115 107118 107272 109344 109345	065169	065554X

ASA-5 Assy. Pc. No.	Service Replacement	Remanufactured Replacement
065171 106195 106205 107103 107106 107176 107262 107273 107297 107995 107999 108647	065170	065560X
065184 106194 107100 107274 107400 107401 107944 107993 108092 108431	065172	065561X
106900 106902 107110 107112 107275	065173	065562X
065183 106204 106207 107105 107108 107143 107144 107179 107276 107402 107403 107421 107536 107991 107996 107997 108068 108645	065174	065563X
065246 106926 107127 107277 107736 107772 107773 107787 108091 108117 109519	065175	065575X

SERVICE REPLACEMENT

ASA-5

CATALOG
05-A-26

ASA-5 Assy. Pc. No.	Service Replacement	Remanufactured Replacement
106202 107102 107279	065177	065567X
065277 106201 107101 107278 107994 108093 108430	065176	065564X
107254 107280	065178	065568X
107264 107265 107281	065179	065576X
107407 107408 107409	065182	065577X
107445 107948	065193	065569X
107446 107947	065194	065570X
107504	065195	065565X
107505	065196	065566X
107687 107688 107689	065221	065574X
106208 106209 107114 107117 107729 107730	065244	065551X

ASA-5 Assy. Pc. No.	Service Replacement	Remanufactured Replacement
107734 107735 107789 107790 108119 108120 109516	065245	065555X
107739 108118 108371 107788 109518	065247	065574X
107142 107178 108000	065274	065558X
107774 107775 109627 109628	065276	065556X
108292 108293 108966 108967 109277 109278 109517	065306	065553X
108555 108974 109038 —	065335 065403	065572X
108617	065344	065573X
109271 109272	065488	065578X
109357	065508	065571X
131026	065700	065579X

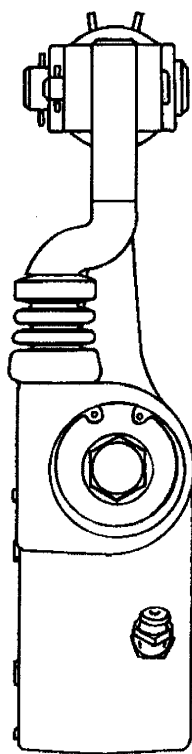
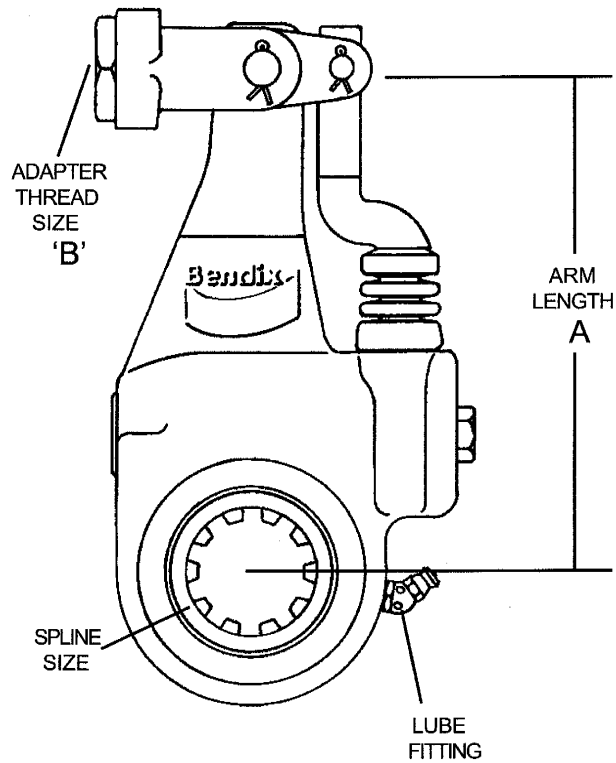

STRAIGHT

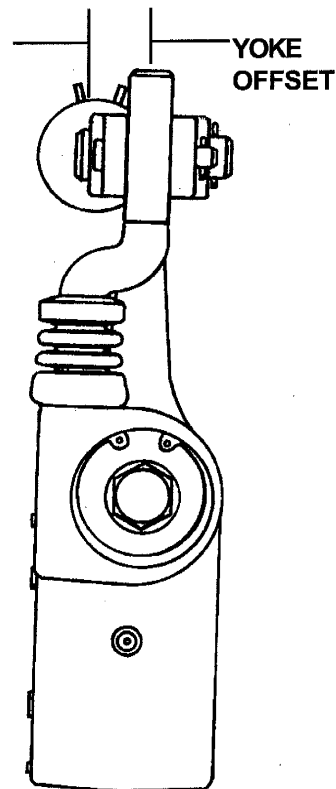

OFFSET

The most commonly used adapter is supplied with the slack adjuster, alternate adapters must be purchased separately.

All offset slack adjusters are provided as shown. If the opposite offset is needed remove the yoke and rotate 180°.

SERVICE PIECE NUMBERS

ASA-5

CATALOG
05-A-28

ASA-5 SERVICE ASSY. PC. NO.	ARM LENGTH A	ADAPTER THREAD SIZE B	YOKE OFFSET	SERVICE PARTS/KITS			COMMENTS
				ADAPTER	YOKE	LINK	
1 1/4"-10C SPLINE							
065162	5"	1/2-20	5/8"	292756	107160	107163	
065163	5 1/2"	5/8-18	5/8"	291452	107160	107164	
065164	5 1/2"	1/2-20	Straight	292756	107158	107164	
065244	5 1/2"	1/2-20	5/8"	292756	107160	107164	
1 1/4"-24 SPLINE							
065166	5"	1/2-20	5/8"	292756	107160	107163	
065167	5 1/2"	5/8-18	Straight	291452	107158	107164	
065274	5 1/2"	1/2-20	Straight	292756	107158	107164	
065306	5 1/2"	1/2-20	5/8"	292756	107160	107164	Worm Gear incorporates a lubrication passage
065335	5 1/2"	1/2-20	Straight	292756	107160	107164	Worm Gear incorporates a lubrication passage
065403	5 1/2"	5/8-18	Straight	291452	107158	107164	Worm Gear incorporates a lubrication passage
1 1/2"-10C SPLINE							
065168	5"	1/2-20	Straight	292756	107158	107163	
065169	5 1/2"	1/2-20	5/8"	292756	107160	107164	
065170	5 1/2"	5/8-18	Straight	291452	107158	107164	
065172	6"	5/8-18	Straight	291452	107158	107165	
065344	6"	5/8-18	Straight	291452	107158	107165	Worm Gear incorporates a lubrication passage
065488	5 1/2"	5/8-18	5/8"	291452	107160	107164	Worm Gear incorporates a lubrication passage
065508	5"	5/8-18	Straight	291452	107158	107163	Worm Gear incorporates a lubrication passage
065700	5 1/2"	5/8-18	Straight	291452	107158	107164	Worm Gear incorporates a lubrication passage
1 1/2"-28 SPLINE							
065173	5"	1/2-20	Straight	292756	107158	107163	
065174	5 1/2"	5/8-18	Straight	291452	107158	107164	
065175	6"	5/8-18	Straight	291452	107158	107165	Worm Gear incorporates a lubrication passage
065176	6"	5/8-18	Straight	291452	107158	107165	
065195	5 1/2"	5/8-18	Straight	291452	107158	107164	Customer Ident. Body
065196	6"	5/8-18	Straight	291452	107158	107165	Customer Ident. Body
065221	5 1/2"	1/2-20	Straight	292756	107158	107164	Worm Gear incorporates a lubrication passage
065245	5 1/2"	1/2-20	5/8"	292756	107160	107164	Worm Gear incorporates a lubrication passage
065247	5 1/2"	5/8-18	Straight	291452	107158	107164	Worm Gear incorporates a lubrication passage
065276	6"	1/2-20	5/8"	292756	107160	107165	Worm Gear incorporates a lubrication passage
1 5/8"-37 SPLINE							
065177	6"	5/8-18	Straight	291452	107158	107165	
065178	5 1/2"	5/8-18	Straight	291452	107158	107164	
065179	6"	5/8-18	Straight	291452	107158	107165	Worm Gear incorporates a lubrication passage
065182	5 1/2"	5/8-18	Straight	291452	107158	107164	Worm Gear incorporates a lubrication passage
065193	5 1/2"	5/8-18	Straight	291452	107158	107164	Customer Ident. Body
065194	6"	5/8-18	Straight	291452	107158	107165	Customer Ident. Body

The easy-on yoke assemblies are standard on the ASA-5 service basic slack adjusters, however early production assemblies may contain the quick connect yoke.

If the quick connect yoke is required it must be purchased separately and installed by the customer.

All ASA-5 slack adjusters are supplied with a 45Y lube fitting unless otherwise noted.

BENDIX AUTOMATIC		
ASA-2	ASA-5	ADAPTER
101261	065174	—
101262	065174	—
101453	065164	—
101454	065164	—
101539	065164	291452
101540	065164	291452
101628	065169	—
101629	065169	—
101769	065174	—
101770	065174	—
101988	065170	—
101989	065170	—
102538	065174	292756
102539	065174	292756
103049	065163	—
103050	065163	—
103206	065174	—
103207	065174	—
103208	—	—
103209	—	—
104446	065164	—
104447	065164	—
104476	065175	—
104477	—	—
106378	065167,065274	—
106379	065167,065274	—
106805	—	—
106806	—	—
106807	—	—
106808	—	—
106824	—	—
106825	—	—
106826	—	—
106958	065170	—
106959	065170	—
107140	065245	291452
107141	065245	291452
289304	065244	—
289305	065244	—
289306	065163,065244	—
289307	065163,065244	—
289312	065176	—
289313	065176	—
289314	065174	—
289315	065174	—
289316	—	—
289317	—	—
289325	065177	—
289652	065172	—

BENDIX AUTOMATIC		
ASA-2	ASA-5	ADAPTER
289653	065172	—
289654	065170	—
289655	065170	—
289656	—	—
289657	—	—
289741	065172	—
289742	065172	—
289746	065170	—
289747	065170	—
289748	065170	292756
289749	065170	292756
289933	065176	—
289934	065176	—

BENDIX MANUAL		
PL-18	ARM LENGTH	ASA-5
103215	5-1/2	065245
103216	5-1/2	065245
278252	4-1/2	—
	5-1/2	065169
278253	4-1/2	—
	5-1/2	065169
278288	4	—
	5	—
278289	4	—
	5	—
278294	4-1/2	—
	5-1/2	065163
278295	4-1/2	—
	5-1/2	065163
279300	5-1/4	—
279301	5-1/4	—
279946	6	—
	7	—
279947	6	—
	7	—
280424	4	—
	5	—
280425	4	—
	5	—
286631	5-1/2	065163
286632	5-1/2	065163
288850	5-1/2	065163
288851	5-1/2	065163

BENDIX MANUAL		
PL-20	ARM LENGTH	ASA-5
101133	5	065173
	6	065176
101134	5-1/2	065174
	6-1/2	—
101220	5-1/2	065174
101289	5-1/2	065174
	6-1/2	—
101290	5	065173
	6	065176
101413	5-1/2	—
101414	5-1/2	—
101821	5-1/2	—
101822	5-1/2	—
101827	6	065172
101853	5-1/2	065170
102104	5-1/2	065170
	6-1/2	—
102106	5-1/2	065174
102972	5-1/2	065170
102984	5-1/2	—
102985	5-1/2	—
	7	—
103013	5-1/2	065174
103122	5-1/2	065170
103345	5	065173
	6	065176
103749	5-1/2	—
	6-1/2	—
103750	5-1/2	—
	6-1/2	—
104239	5	065173
	6	065176
106476	5-1/2	065174
106477	6	065176
106832	5-1/2	065167
106833	5-1/2	065164
106834	5-1/2	065167
106924	5-1/2	065174
	6-1/2	—
107936	5-1/2	065170
107937	5-1/2	065174
277959	5-1/2	065170
	6-1/2	—
278121	6	—
278122	6	—
278302	4-1/2	—
	5-1/2	065164
278303	5	—
	6	—

SLACK ADJUSTER CHANGE OVER

ASA-5

CATALOG
05-A-30

BENDIX MANUAL		
PL-20	ARM LENGTH	ASA-5
278304	4	—
	5	—
	6	—
278305	5	—
	6	—
	7	—
278312	5	065168
	6	065172
278313	4	—
	5	065168
278321	5-1/2	065170
	6-1/2	—
278323	5	065168
	6	065172
	7	—
278326	4-1/2	—
	5-1/2	065170
	6-1/2	—
278330	4	—
	5	—
278334	5	065168
	6	065172
278335	6	065172
	7	—
278719	6	065172
	7	—
279302	5-1/4	—
279303	5-1/4	—
279308	5-3/4	—
279309	5-3/4	—
279315	4	—
	5	065168
279316	4-1/2	—
	5-1/2	065170
279350	7	—
279351	7	—
281777	5-1/2	065170
281983	5-1/2	065170
	6-1/2	—
281984	5	065168
	6	065172
283411	6	065177
	6	065176
286168	7	—
286965	5	065173
	6	065176
287888	7	—
287889	7	—
287896	6-1/2	—
287897	6-1/2	—

BENDIX MANUAL		
PL-20	ARM LENGTH	ASA-5
288282	7	—
288539	6-1/2	—
288540	6-1/2	—
288541	6	—
288542	6	—
288753	5-1/2	065174
	6-1/2	—
289856	6	—
289857	6	—
289858	5-1/2	065174

COMPETITIVE - AUTOMATIC SLACK ADJUSTER		
EATON	ARM LENGTH	ASA-5
808112	5	065168
	6	065172
808113	6	065176
808114	5	065168
	6	065172
808115	5-1/2	065174
	6-1/2	—
808116	5-1/2	065170
	6-1/2	—
808117	5	—
	6	065177
808118	5	065168
	6	065172
808119	5-1/2	065169
808120	5-1/2	065169
808121	5-1/2	065163
808122	5-1/2	065163
808123	5-1/2	065164
	6-1/2	—
808124	5	065168
	6	065172
808125	5-1/2	065170
	6-1/2	—
808126	5	065173
	6	065176
808127	5-1/2	—
808128	5-1/2	—
808129	5	065173
	6	065176
808130	5	065173
	6	065176
808131	5-1/2	065174
	6-1/2	—
808132	5-1/2	065174
	6-1/2	—
808133	6	065177

COMPETITIVE - AUTOMATIC SLACK ADJUSTER		
EATON	ARM LENGTH	ASA-5
808134	5-1/2	065174
	6-1/2	—
808135	5	065168
	6	065172
808136	5-1/2	065170
	6-1/2	—
808137	5	065173
	6	065176
808138	5-1/2	065174
	6-1/2	—
808139	5-1/2	065170
	6-1/2	—
808140	5	065168
	6	065172
808141	5-1/2	065174
	6-1/2	—
808142	5	065173
	6	065176
808143	5-1/2	065170
	6-1/2	—
808144	5-1/2	—
808145	5-1/2	—
808146	5	065168
	6	065172
808147	5-1/2	065167
	6-1/2	—
808375	5	065168
	6	065172

COMPETITIVE - AUTOMATIC SLACK ADJUSTER		
EUCLID	ARM LENGTH	ASA-5
E-036	7	—
E-051	5	065168
	6	065172
E-108	5-1/2	065170
	6-1/2	—
E-128	5-1/2	065163
	6-1/2	—
E-167	5	065173
	6	065176
E-168	5-1/2	065174
	6-1/2	—
E-172	5-1/2	065167
E-224	5-1/2	065167
E-257	5-1/2	065170
E-258	5-1/2	065174

COMPETITIVE - AUTOMATIC SLACK ADJUSTER		
EUCLID	ARM LENGTH	ASA-5
E-294	5-1/2	065170
	6-1/2	—
E-319	5-1/2	065167
	6-1/2	—
E-325	5-1/2	065163
E-326	5-1/2	065163
E-364	5-1/2	065167
E-416	5-1/2	065173
E-442	6	065172
E-443	6	065176
E-444	5-1/2	065173
	6-1/2	—

COMPETITIVE - AUTOMATIC SLACK ADJUSTER		
GUNITE	ARM LENGTH	ASA-5
AS1000	6	065172
AS1001	6	065176
AS1002	6	065177
AS1003	5-1/2	065170
	6-1/2	065169
AS1004	5-1/2	065174
	6-1/2	065245
AS1005	5-1/2	065164
	6-1/2	065163
AS1006	5-1/2	065178
	6-1/2	—
AS1007	5-1/2	065167
AS1011	5-1/2	065167
AS1012	5-1/2	065174
	6-1/2	065245

COMPETITIVE - AUTOMATIC SLACK ADJUSTER		
HALDEX	ARM LENGTH	ASA-5
409-10051	5	065168
	6	065172
409-10070	6	065176
409-10086	5	065168
	6	065172
409-10091	5-1/2	065174
	6-1/2	—
409-10108	5-1/2	065170
	6-1/2	—
409-10110	5	—
	6	065177

COMPETITIVE - AUTOMATIC SLACK ADJUSTER		
HALDEX	ARM LENGTH	ASA-5
409-10111	5	065168
	6	065172
409-10112	5-1/2	065169
409-10113	5-1/2	065169
409-10114	5-1/2	065163
409-10115	5-1/2	065163
409-10128	5-1/2	065164
	6-1/2	—
409-10130	5	065168
	6	065172
409-10135	5-1/2	065170
	6-1/2	—
409-10146	5	065173
	6	065176
409-10147	5-1/2	—
409-10148	5-1/2	—
409-10149	5	065173
	6	065176
409-10151	5	065173
	6	065176
409-10168	5-1/2	065174
	6-1/2	—
409-10215	5-1/2	065174
	6-1/2	—
409-10218	6	065177
409-10229	5-1/2	065174
	6-1/2	—
409-10230	5	065168
	6	065172
409-10231	5	065168
	6	065172
409-10232	5-1/2	065170
	6-1/2	—
409-10233	5-1/2	065170
	6-1/2	—
409-10234	5	065173
	6	065176
409-10235	5	065173
	6	065176
409-10236	5-1/2	065174
	6-1/2	—
409-10237	5-1/2	065174
	6-1/2	—
409-10238	5-1/2	065170
	6-1/2	—
409-10239	5	065168
	6	065172
409-10240	5-1/2	065174
	6-1/2	—

COMPETITIVE - AUTOMATIC SLACK ADJUSTER		
HALDEX	ARM LENGTH	ASA-5
409-10241	5	065173
	6	065176
409-10294	5-1/2	065170
	6-1/2	—
409-10304	5-1/2	—
409-10305	5-1/2	—
409-10318	5	065168
	6	065172
109-10319	5-1/2	065167
	6-1/2	—

COMPETITIVE - AUTOMATIC SLACK ADJUSTER		
KELSEY	ARM LENGTH	ASA-5
550010	5-1/2	065163
556510	5-1/2	065170
	6-1/2	—
556528	5-1/2	065174
	6-1/2	—
600010	6	065172
600028	6	065176
600037	6	065177

SLACK ADJUSTER CHANGE OVER

ASA-5

CATALOG
05-A-32

COMPETITIVE-AUTOMATIC SLACK ADJUSTER			
MIDLAND AUTOMATIC	ARM LENGTH	ASA-5	YOKE ADAPTER
KN52201	6	065172	292756
KN52202	6	065172	292756
KN52203	6	—	292756
KN52204	6	—	292756
KN52211	6	065176	—
KN52212	6	065176	292756
KN52213	6	065276	292756
KN52214	6	065276	—
KN52221	6	065177	—
KN52222	6	065177	292756
KN52223	6	—	—
KN52224	6	—	—
KN52231	5-1/2 6-1/2	065170	— —
KN52232	5-1/2 6-1/2	065170	292756 —
KN52233	5-1/2 6-1/2	065169	— 291452
KN52234	5-1/2 6-1/2	065169	— —
KN52241	5-1/2 6-1/2	065174	— —
KN52242	5-1/2 6-1/2	—	— —
KN52243	5-1/2 6-1/2	—	— —
KN52244	5-1/2 6-1/2	—	— —
KN52251	5-1/2	065164	—
KN52252	5-1/2	065164	292756
KN52253	5-1/2	065163	—
KN52254	5-1/2	065163	292756
KN52261	5-1/2 6-1/2	065178	— —
KN52262	5-1/2 6-1/2	065178	292756 —
KN52263	5-1/2 6-1/2	—	— —
KN52264	5-1/2 6-1/2	—	— —
KN52271	5-1/2	065167	—
KN52272	5-1/2	065167	292756
KN52273	5-1/2	—	—
KN52274	5-1/2	—	—

COMPETITIVE - MANUAL SLACK ADJUSTER		
MIDLAND MANUAL	ARM LENGTH	ASA-5
KN44041	6	065177
KN47001	5 6 7	065168 065172 —
KN47011	5-1/2 6-1/2	065170 —
KN44051	5 6	065173 065176
KN44061	5-1/2 6-1/2	065174 —
KN47081	5 6	065168 065172
KN48001	5 6	— —
KN49000	4-1/2 5-1/2	— 065169
KN49010	4-1/2 5-1/2	— 065169
KN49020	4 5	— —
KN49030	4 5	— —
KN50000	4-1/2 5-1/2	— 065169
KN50010	4-1/2 5-1/2	— 065169
KN50020	5 6	— —
KN50030	5 6	— —
KN50040	4 5	— —
KN50050	4 5	— —
N21133A	4 5	— —
N21133B	4 5	— —
N21133C	5 6	— —
N21133D	5 6	— —
N21133E	4-1/2 5-1/2	— 065169
N21133F	4-1/2 5-1/2	— 065169

COMPETITIVE - MANUAL SLACK ADJUSTER		
MIDLAND MANUAL	ARM LENGTH	ASA-5
N21133N	4 5 6	— — —
N21133P	4 5 6	— — —
N21133GA	4 5	— —
N21133GB	4 5	— —
N21133GC	4-1/2 5-1/2	— 065169
N21133GD	4-1/2 5-1/2	— 065169
N21133GJ	5-1/2	065169
N21133GK	5-1/2	065169
N21145A	5 6 7	— — —
N21145B	5 6	— —
N21145C	5	—
N21145D	5-1/2	065164
N21145E	4 5	— —
N21145F	4-1/2 5-1/2	— 065164
N21146A	5 6	065168 065172
N21146B	5-1/2 6-1/2	065170 —
N21146C	5-1/2	065170
N21146D	5-1/2 6-1/2	065170 —
N21146E	5 6	065168 065172
N21146F	5 6	065168 065172
N21146G	5	065168
N21146H	5 6 7	065168 065172 —
N21146J	5 6	065168 065172
N21146K	5-1/2	065170
N21146L	6	065172
N21146M	4-1/2 5-1/2	— 065170

**SLACK ADJUSTER
CHANGE OVER**

COMPETITIVE - MANUAL SLACK ADJUSTER		
MIDLAND MANUAL	ARM LENGTH	ASA-5
N21146N	5-1/2	065170
N21146P	5-1/2 6-1/2	065170 —
N21146R	5	065168
N21146S	6	065172
N21147A	6	065177
N21148A	5 6	065173 065176
N21148B	5-1/2 6-1/2	065174 —
N21148C	5 6	065173 065176
N21148D	5-1/2 6-1/2	065174 —
N21148E	5-1/2	065174
N21148F	5-1/2	065174
N21148G	5 6	065173 065176
N21148H	5 6 7	065173 065176 —
N21148K	5	065173

COMPETITIVE - AUTOMATIC SLACK ADJUSTER				
ROCKWELL AUTOMATIC	ARM LENGTH	ASA-5	YOKE ADAPTER	
A1-3275-A-599-S	5-1/2	—	—	
A1-3275-B-600-S	6	—	—	
A1-3275-C-601-S	6-1/2	—	—	
A1-3275-N-716-S	6	—	—	
A1-3275-N-768-S	5-1/2	—	—	
A1-3275-P-718-S	6-1/2	—	—	
A1-3275-U-593-S	5-1/2	—	—	
A1-3275-V-594-S	6	—	—	
A1-3275-W-595-S	6-1/2	—	—	
A2-3275-B-600-S	6	065176	—	
A2-3275-C-601-S	6-1/2	—	—	
A2-3275-N-768-S	5-1/2	—	—	
A2-3275-P-718-S	6-1/2	—	—	
A2-3275-U-593-S	5-1/2	—	—	
A2-3275-V-594-S	6	065176	—	
A2-3275-W-595-S	6-1/2	—	—	
A2-3275-A-599-S	5-1/2	—	—	
A4-3275-N-768-S	5-1/2	065164	292756	
A6-3275-A-599-S	5-1/2	065170	292756	
A6-3275-T-592-S	5	—	—	
A6-3275-Z-598-S	5	—	—	
A7-3275-A-599-S	5-1/2	065164	292756	
A7-3275-T-592-S	5	065162	—	
A7-3275-U-593-S	5-1/2	065170	292756	
A8-3275-A-599-S	5-1/2	065163	292756	
A8-3275-T-592-S	5	065168	—	
A8-3275-U-593-S	5-1/2	065164	292756	
A8-3275-Z-598-S	5	065168	—	
A9-3275-A-599-S	5-1/2	065170	292756	
A9-3275-T-592-S	5	—	—	
A9-3275-U-593-S	5-1/2	065163	292756	
A9-3275-Z-598-S	5	—	—	
A10-3275-A-599-S	5-1/2	065169	—	
A10-3275-N-716-S	6	065176	—	
A10-3275-T-592-S	5	065173	—	
A10-3275-U-593-S	5-1/2	065170	292756	
A10-3275-Z-598-S	5	065173	—	
A11-3275-A-599-S	5-1/2	065163	292756	
A11-3275-U-593-S	5-1/2	065169	—	
A12-3275-N-716-S	6	065177	—	
A12-3275-T-592-S	5	—	—	
A12-3275-U-593-S	5-1/2	065163	292756	
A12-3275-Z-598-S	5	—	—	
A13-3275-C-601-S	6-1/2	—	—	

COMPETITIVE - AUTOMATIC SLACK ADJUSTER				
ROCKWELL AUTOMATIC	ARM LENGTH	ASA-5	YOKE ADAPTER	
A13-3275-N-716-S	6	—	—	
A13-3275-N-768-S	5-1/2	—	—	
A13-3275-W-595-S	6-1/2	—	—	
A14-3275-A-599-S	5-1/2	065164	292756	
A14-3275-B-600-S	6	065172	—	
A14-3275-V-594-S	6	065172	—	
A15-3275-U-593-S	5-1/2	065164	292756	
A16-3275-A-599-S	5-1/2	—	—	
A16-3275-B-600-S	6	065176	—	
A16-3275-V-594-S	6	065176	—	
A17-3275-A-599-S	5-1/2	—	—	
A17-3275-U-593-S	5-1/2	—	—	
A18-3275-B-600-S	6	065177	—	
A18-3275-N-716-S	6	065177	—	
A18-3275-U-593-S	5-1/2	—	—	
A18-3275-V-594-S	6	065177	—	
A20-3275-N-768-S	5-1/2	065178	—	
A21-3275-A-599-S	5-1/2	—	—	
A21-3275-B-600-S	6	065177	—	
A21-3275-N-768-S	5-1/2	065174	—	
A21-3275-U-593-S	5-1/2	—	—	
A21-3275-V-594-S	6	065177	—	
A22-3275-N-768-S	5-1/2	065170	—	
A29-3275-A-599-S	5-1/2	—	—	
A29-3275-U-593-S	5-1/2	—	—	
A40-3275-A-599-S	5-1/2	065167	292756	
A40-3275-U-593-S	5-1/2	065167	292756	
A41-3275-A-599-S	5-1/2	065167	292756	
A41-3275-U-593-S	5-1/2	065167	292756	
A42-3275-A-599-S	5-1/2	065170	—	
A42-3275-U-593-S	5-1/2	065170	—	
A43-3275-A-599-S	5-1/2	065170	—	
A43-3275-U-593-S	5-1/2	065170	—	
A44-3275-A-599-S	5-1/2	065174	—	
A44-3275-U-593-S	5-1/2	065174	—	
A45-3275-A-599-S	5-1/2	065178	—	
A45-3275-U-593-S	5-1/2	065178	—	
A47-3275-A-599-S	5-1/2	065164	—	
A47-3275-U-593-S	5-1/2	065164	—	
A52-3275-A-599-S	5-1/2	065167	—	
A52-3275-U-593-S	5-1/2	065167	—	
A55-3275-U-593-S	5-1/2	—	—	
A56-3275-A-599-S	5-1/2	065174	—	
A56-3275-U-593-S	5-1/2	065174	—	