

Bendix ABS for Trailers

Antilock Systems and Components

Bendix EC-30 ABS

Pages 13-TLR-1 to 13-TLR-13



Gen 4 and Gen 5 ABS

(formerly marketed under the Eaton® brand name)

Pages 13-TLR-14 to 13-TLR-20



**IMPORTANT
REPLACEMENT INFORMATION**

The **MC-12** Modulator Controller and all of its subassemblies and components are **OBSOLETE** and must be replaced with a complete MC-30 assembly and pigtail wire harness. MC-30 conversion kits, which contain both the MC-30 and the appropriate pigtail wire harness, have been developed to assist in the change over. Refer to the MC-30 Conversion Kit Catalog Page for kit contents.

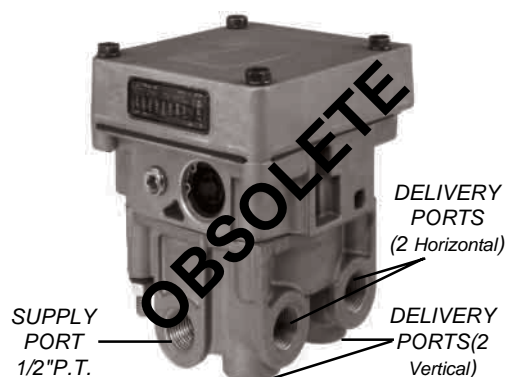

BRACKET MOUNTED MC-12



RESERVOIR MOUNTED MC-12

BRACKET MOUNTED MC-12 4 PSI CRACK PRESSURE		
MC-12 Pc. No.	Replace With MC-30 Kit	MC-30 Equivalent¹
65366	Kit Group 2	800820
550450	Kit Group 2	800820
800138	Kit Group 2	800820
5001628	Kit Group 2	800820

NOTE 1: MC-30 that is similar to the MC-12 shown in the left column

**IMPORTANT
REPLACEMENT KIT NOTE**

Each Kit Group (1, 2, & 3) contains five different replacement kit numbers. The difference between the five replacement kits is the type of connector used on the power lead of and the length of the power lead on the pigtail wiring harness included in the kit. Power leads can have either a 3, 4 or 5 pin connector and the lead can be either 19.5 feet or 5 feet in length.

See the MC-30 Conversion Kit Catalog Page for kit contents and additional information.

RESERVOIR MOUNTED MC-12 4 PSI CRACK PRESSURE		
MC-12 Pc. No.	Replace With MC-30 Kit	MC-30 Equivalent¹
65281	Kit Group 1	800737
65447	Kit Group 1	800737
65524	Kit Group 1	800737
550289	Kit Group 1	800737
550711	Kit Group 1	800737
800574	Kit Group 1	800737
800834	Kit Group 1	800737
5001139	Kit Group 1	800737
5005543	Kit Group 1	800737
5008309	Kit Group 1	800737

NOTE 1: MC-30 that is similar to the MC-12 shown in the left column

RESERVOIR MOUNTED MC-12 5.5 PSI CRACK PRESSURE		
MC-12 Pc. No.	Replace With MC-30 Kit	MC-30 Equivalent¹
65530	Kit Group 3	801132
550719	Kit Group 3	801132

NOTE 1: MC-30 that is similar to the MC-12 shown in the left column

IMPORTANT REPLACEMENT INFORMATION

The **MCE-12** Modulator Controller for converter dollies and all of its subassemblies and components are **OBSOLETE** and must be replaced with a complete MC-30 assembly and pigtail wire harness. MC-30 conversion kits, which contain the MC-30, the appropriate pigtail wire harness and air valves, have been developed to assist in the change over. Refer to the MC-30 Conversion Kit Catalog Page for kit contents.

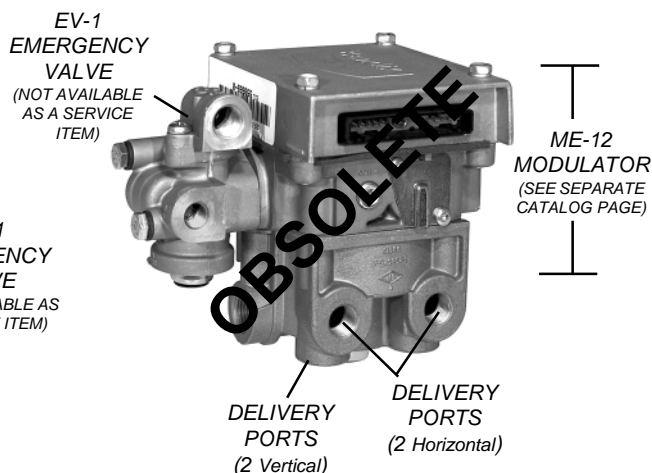
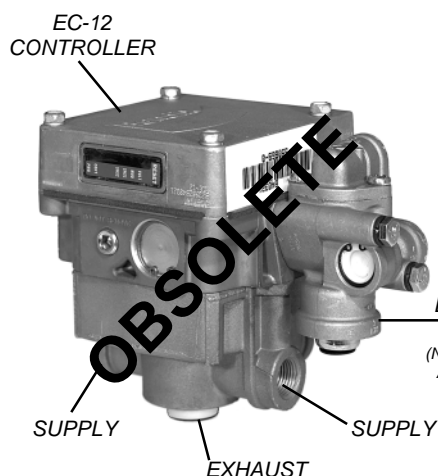

BRACKET MOUNTED MCE-12 4 PSI CRACK PRESSURE

MCE-12 Pc. No.	Replace With MC-30 Kit	MC-30 Equivalent ¹
65297	Kit Group 4	800820
65396	Kit Group 4	800820
65422	Kit Group 4	800820
65444	Kit Group 4	800820
65639	Kit Group 4	800820
550714	Kit Group 4	800820
800368	Kit Group 4	800820
5003959	Kit Group 4	800820

NOTE 1: MC-30 that is similar to the MCE-12 shown in the left column

BRACKET MOUNTED MCE-12 5.5 PSI CRACK PRESSURE

MCE-12 Pc. No.	Replace With MC-30 Kit	MC-30 Equivalent ¹
800547	Kit Group 5	801133
5005226	Kit Group 5	801133

NOTE 1: MC-30 that is similar to the MCE-12 shown in the left column

IMPORTANT REPLACEMENT KIT NOTE

Each Kit Group (4 & 5) contains five different replacement kit numbers. The difference between the five replacement kits is the type of connector used on the power lead of and the length of the power lead on the pigtail wiring harness included in the kit. Power leads can have either a 3, 4 or 5 pin connector and the lead can be either 19.5 feet or 5 feet in length.

See the MC-30 Conversion Kit Catalog Page for kit contents and additional information.

**IMPORTANT
REPLACEMENT INFORMATION**

The **EC-12** Controller is **OBSOLETE** and must be replaced with a complete MC-30 modulator controller assembly. A series of MC-30 conversion kits have been developed to assist in the change over.

Because the EC-12 cannot be replaced without also replacing the modulator it controls, it is necessary to determine the style and crack pressure of the modulator assembly. A kit group containing five different kits is shown for each modulator style. The difference between the five replacement kits is the type of connector used on the power lead of and the length of the power lead on the pigtail wiring harness included in the kit. Power leads can have either a 3, 4 or 5 pin connector and the lead can be either 19.5 feet or 5 feet in length.

See the MC-30 Conversion Kit Catalog Page for kit contents and additional information.



EC-12 CONTROLLER

BRACKET MOUNTED MC-12



RESERVOIR MOUNTED MC-12



BRACKET MOUNTED MCE-12



**BRACKET MOUNTED MC-12
4 PSI CRACK PRESSURE**

Use one of the five kits in Kit
GROUP 2 to replace this style
MC-12

**RESERVOIR MOUNTED MC-12
4 PSI CRACK PRESSURE**

Use one of the five kits in Kit
GROUP 1 to replace this style
MC-12

**RESERVOIR MOUNTED MC-12
5.5 PSI CRACK PRESSURE**

Use one of the five kits in Kit
GROUP 3 to replace this style
MC-12

**BRACKET MOUNTED MCE-12
4 PSI CRACK PRESSURE**

Use one of the five kits in Kit
GROUP 4 to replace this style
MC-12

**BRACKET MOUNTED MCE-12
5.5 PSI CRACK PRESSURE**

Use one of the five kits in Kit
GROUP 5 to replace this style
MC-12

IMPORTANT REPLACEMENT INFORMATION

The **M-12** Modulator is **OBSOLETE** and must be replaced with a complete MC-30 assembly and pigtail wire harness. MC-30 conversion kits, which contain both the MC-30 and the appropriate pigtail wire harness, have been developed to assist in the change over. Refer to the MC-30 Conversion Kit Catalog Page for kit contents.

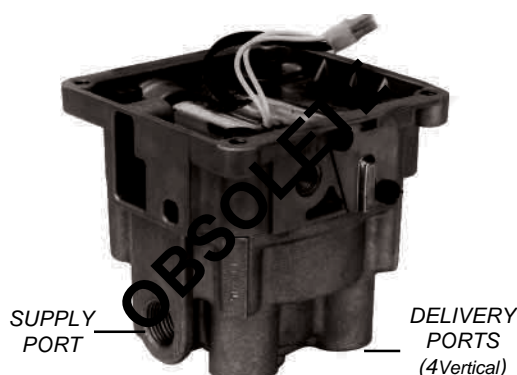

RESERVOIR MOUNTED MC-12

RESERVOIR MOUNTED M-12 4 PSI CRACK PRESSURE	
M-12 Pc. No.	Replace With MC-30 Kit
65282	Kit Group 1
65448	Kit Group 1
550291	Kit Group 1
550579	Kit Group 1

RESERVOIR MOUNTED MC-12 5.5 PSI CRACK PRESSURE	
MC-12 Pc. No.	Replace With MC-30 Kit
65531	Kit Group 3
550721	Kit Group 3

IMPORTANT REPLACEMENT KIT NOTE

Either of two (2) MC-30 kits can be used to replace each M-12. The difference between the two replacement kits shown for each M-12 is the length of the pigtail wiring harness included in the kit.

The first replacement kit part number shown contains a pigtail harness that is **5 feet in length** while the second kit part number contains a pigtail harness that is **19.5 feet in length**.

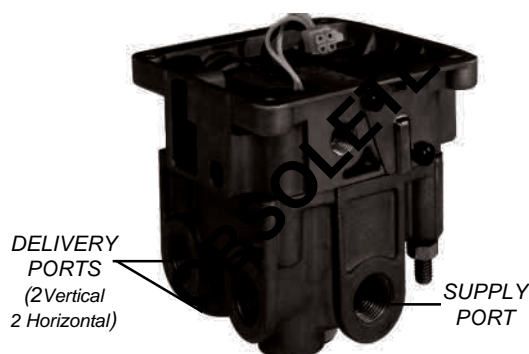

BRACKET MOUNTED MC-12

BRACKET MOUNTED M-12 4 PSI CRACK PRESSURE	
M-12 Pc. No.	Replace With MC-30 Kit
65346	Kit Group 2
65367	Kit Group 2
65392	Kit Group 2
550423	Kit Group 2
550452	Kit Group 2
550514	Kit Group 2

M-12 MAINTENANCE KIT 102802

Is still available to service the lower relay valve section of the modulator. Solenoid and electrical components and subassemblies are not available. The following parts are contained in the kit:

QTY.	DESCRIPTION
1	RETAINING RING
1	EXH COVER CPL
1	O-RING
1	O-RING
1	VALVE SPRING
1	VALVE RETAINER
1	INL & EXH VALVE
1	O-RING
1	O-RING

Note: The gasket (560355) used between the controller and M-12 modulator must be purchased separately. Detail parts other than those listed above are not available for service.

**IMPORTANT
REPLACEMENT INFORMATION**

The **ME-12** Modulator is **OBSOLETE** and must be replaced with a complete MC-30 assembly and pigtail wire harness. MC-30 conversion kits, which contain the MC-30, appropriate pigtail wire harness and required air valving, have been developed to assist in the change over. Refer to the MC-30 Conversion Kit Catalog Page for kit contents.
A maintenance kit for the ME-12 is still available and shown here.

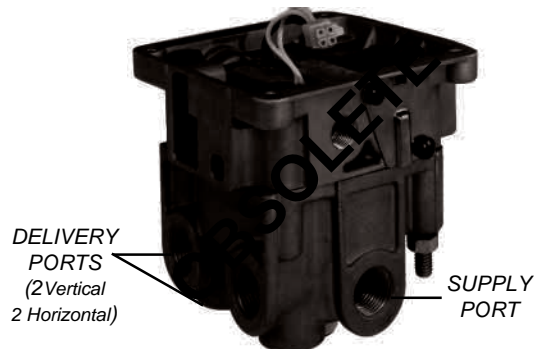

BRACKET MOUNTED ME-12

**BRACKET MOUNTED ME-12
4 PSI CRACK PRESSURE**

ME-12 Pc. No.	Replace With MC-30 Kit Pc. No.
65644	Kit Group 4

**BRACKET MOUNTED ME-12
5.5 PSI CRACK PRESSURE**

ME-12 Pc. No.	Replace With MC-30 Kit Pc. No.
800548	Kit Group 5

ME-12 MAINTENANCE KIT 102802

Is still available to service the lower relay valve section of the modulator. Solenoid and electrical components and subassemblies are not available. The following parts are contained in the kit:

QTY.	DESCRIPTION
1	RETAINING RING
1	EXH COVER CPL
1	O-RING
1	O-RING
1	VALVE SPRING
1	VALVE RETAINER
1	INL & EXH VALVE
1	O-RING
1	O-RING

Note: The gasket (560355) used between the controller and ME-12 modulator must be purchased separately. Detail parts other than those listed above are not available for service.

IMPORTANT REPLACEMENT KIT NOTE

Either of two (2) MC-30 kits can be used to replace each ME-12. The difference between the two replacement kits shown for each ME-12 is the length of the pigtail wiring harness included in the kit.

The first replacement kit part number shown contains a pigtail harness that is **5 feet in length** while the second kit part number contains a pigtail harness that is **19.5 feet in length**.



MC-30 BRKT. MT



MC-30 RES. MT.



PIGTAIL WIRE HARNESS

MC-12 TO MC-30 TRAILER CONVERSION KITS CONTAIN:

QTY.	PC. NO.	DESCRIPTION
1	SEE CHART	MC-30 MODULATOR CONTROLLER ASSY
1	SEE CHART	PIGTAIL WIRE HARNESS

Kit Pc. Nos.	MC-30 Assembly			Pigtail Wire Harness		
	MC-30 Pc. No.	Mtg. Config.	Crack Press.	Assy. Pc. No.	Power Conn.	Lead Length
Kit Group 1						
5008564	800736	Res.	4 psi	800776	5 Pin	5 Ft.
5008567	800736	Res.	4 psi	800779	5 Pin	19.5 Ft.
5010953	800736	Res.	4 psi	5010681	4 Pin	17 In.
5010958	800736	Res.	4 psi	5010373	4 Pin	8 Ft.
5010963	800736	Res.	4 psi	5010680	3 Pin	17 In.
Kit Group 2						
5008565	800819	Brht.	4 psi	800776	5 Pin	5 Ft.
5008568	800819	Brht.	4 psi	800779	5 Pin	19.5 Ft.
5010954	800819	Brht.	4 psi	5010681	4 Pin	17 In.
5010959	800819	Brht.	4 psi	5010373	4 Pin	8 Ft.
5010964	800819	Brht.	4 psi	5010680	3 Pin	17 In.
Kit Group 3						
5009732	801132	Res.	5.5 psi	800776	5 Pin	5 Ft.
5009734	801132	Res.	5.5 psi	800779	5 Pin	19.5 Ft.
5010956	801132	Res.	5.5 psi	5010681	4 Pin	17 In.
5010961	801132	Res.	5.5 psi	5010373	4 Pin	8 Ft.
5010966	801132	Res.	5.5 psi	5010680	3 Pin	17 In.



MC-30 BRKT. MT

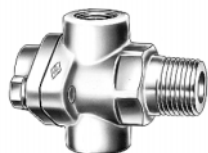

DC-4
PC. NO. 278615



PIGTAIL WIRE HARNESS



TR-3
PC. NO. 101450

MCE-12 TO MC-30 DOLLY CONVERSION KITS CONTAIN:

QTY.	PC. NO.	DESCRIPTION
1	SEE CHART	MC-30 MODULATOR CONTROLLER ASSY
1	SEE CHART	PIGTAIL WIRE HARNESS
1	101450	TR-3 INVERSION VALVE
1	278615	DC-4 DOUBLE CHECK VALVE

Kit Pc. Nos.	MC-30 Assembly			Pigtail Wire Harness		
	MC-30 Pc. No.	Mtg. Config.	Crack Press.	Assy. Pc. No.	Power Conn.	Lead Length
Kit Group 4						
5008566	800819	Brkt.	4 psi	800776	5 Pin	5 Ft.
5008560	800819	Brkt.	4 psi	800779	5 Pin	19.5 Ft.
5010955	800819	Brkt.	4 psi	5010681	4 Pin	17 In.
5010960	800819	Brkt.	4 psi	5010373	4 Pin	8 Ft.
5010965	800819	Brkt.	4 psi	5010680	3 Pin	17 In.
Kit Group 5						
5009733	801133	Brkt.	5.5 psi	800776	5 Pin	5 Ft.
5009735	801133	Brkt.	5.5 psi	800779	5 Pin	19.5 Ft.
5010957	801133	Brkt.	5.5 psi	5010681	4 Pin	17 In.
5010962	801133	Brkt.	5.5 psi	5010373	4 Pin	8 Ft.
5010967	801133	Brkt.	5.5 psi	5010680	3 Pin	17 In.

MC-30 MODULATOR CONTROLLER ASSEMBLY

The MC-30 is the Bendix Antilock Braking System (ABS) controller assembly intended for application on air braked heavy duty trailers, semi-trailers and dollies. The Bendix MC-30 incorporates an integral LED diagnostic display with magnetic reset for easy diagnostics and fault code clearing. Blink code diagnostics are standard and advanced diagnostic tool support is also available. MC-30 supports PLC communication for warning lamp, full diagnostics capability. Other customized options are available in this feature rich ABS system. The ABS function of the MC-30 is designed to provide a towed vehicle with improved stability and control during braking while providing the maximum available braking force. For complete information see Bendix Service Data Sheet SD-13-4834.



BRACKET MOUNTED MC-30

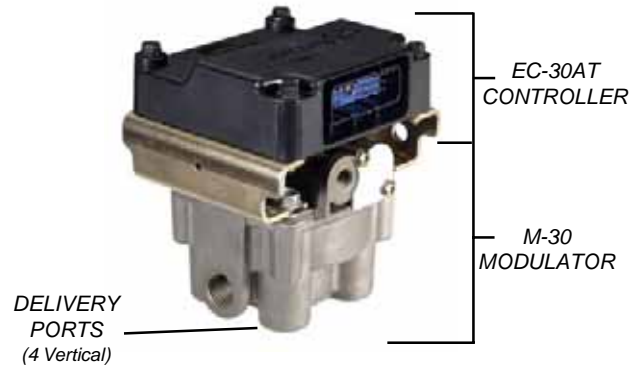

RESERVOIR MOUNTED MC-30



RESERVOIR MOUNTED MC-30

MC-30 CHANGEOVER	
Pc. No.	Service Pc. No.
5007641	801241
5007642	801241
5007643	801242
5007644	801242
5007645	801241
5007646	801242
5008263	801245
5008264	801245
5008265	801247
5008266	801247
5008267	801245
5008268	801247

MC-30 CHANGEOVER	
Pc. No.	Service Pc. No.
5010569	801231
5010612	801241
5010613	801241
5010614	801241
5010615	801241
5010616	801241
5010617	801241
5010618	801242
5010619	801242
5010620	801242
5010621	801242

MC-30 CHANGEOVER	
Pc. No.	Service Pc. No.
5008502	801241
5008503	801241
5008504	801241
5008505	801242
5008506	801242
5008507	801242
5008533	801245
5008534	801245
5008535	801245
5008536	801247
5008537	801247
5008538	801247

MC-30 CHANGEOVER	
Pc. No.	Service Pc. No.
5010622	801242
5010623	801242
5010624	801243
5010625	801243
5010626	801243
5010627	801245
5010628	801245
5010629	801245
5010630	801245
5010631	801245
5010632	801245

MC-30 CHANGEOVER	
Pc. No.	Service Pc. No.
5009157	801248
5009526	801246
5009710	801243
5009711	801243
5009713	801249
5009714	801249
5009722	801132
5009723	801133
5010027	801243
5010028	801249
5010568	801230

MC-30 CHANGEOVER	
Pc. No.	Service Pc. No.
5010633	801246
5010634	801247
5010635	801247
5010636	801247
5010637	801247
5010638	801247
5010639	801247
5010640	801248
5010641	801249
5010642	801249
5010643	801249

MC-30 Serv. Pc. No.	Mtg.	EC-30 Serv. Pc. No.	M-30 Serv. Pc. No.	Crack Press.	EC-30 Rotn. (Note 1)	Horiz. Del. Ports	Vert. Del. Ports	Potential MC-30 Replcmt.	Comments (Note 2)
800736	Res.	800734	800740	4	90		4 - 3/8 PT	801241	No PLC
800737	Res.	800735	800740	4	90		4 - 3/8 PT	801242	
800819	Brkt.	800734	800821	4	90	2 - 3/8 PT	2 - 3/8 PT	801245	No PLC
800820	Brkt.	800735	800821	4	90	2 - 3/8 PT	2 - 3/8 PT	801247	
801033	Brkt.	800735	800821	4	270	2 - 3/8 PT	2 - 3/8 PT	801248	
801104	Brkt.	800734	800821	4	270	2 - 3/8 PT	2 - 3/8 PT	801246	No PLC
801132	Res.	800735	801135	5.5	90		4 - 3/8 PT	801243	
801133	Brkt.	800735	801136	5.5	90	2 - 3/8 PT	2 - 3/8 PT	801249	
801230	Res.	801229	800740	4	90		4 - 3/8 PT		Steer Axle Control
801231	Brkt.	801229	800821	4	90	2 - 3/8 PT	2 - 3/8 PT		Steer Axle Control
801241	Res.	801267	800740	4	90		4 - 3/8 PT		No PLC
801242	Res.	801268	800740	4	90		4 - 3/8 PT		
801243	Res.	801268	801135	5.5	90		4 - 3/8 PT		
801245	Brkt.	801267	800821	4	90	2 - 3/8 PT	2 - 3/8 PT		No PLC
801246	Brkt.	801267	800821	4	270	2 - 3/8 PT	2 - 3/8 PT		No PLC
801247	Brkt.	801268	800821	4	90	2 - 3/8 PT	2 - 3/8 PT		
801248	Brkt.	801268	800821	4	270	2 - 3/8 PT	2 - 3/8 PT		
801249	Brkt.	801268	801136	5.5	90	2 - 3/8 PT	2 - 3/8 PT		

NOTE 1: Rotation orientation is: looking at the modulator exhaust port and rotating clockwise. Rotation is from the centerline of the EC-30T (30 pin) connector to the centerline of the bracket for bracket mounted M-30s and from the centerline of the supply port to the centerline of the EC-30T (30 pin) connector for the reservoir mount M-30s.

NOTE 2: Effective March 1, 2001 all towed vehicles must transmit a signal to control an in-cab trailer ABS warning lamp. Trailers built after this date will transmit the status of the trailer ABS unit over the ignition power wire (blue wire of the J560 connector) using Power Line Carrier (PLC) communications. Trailer built before this date can use ABS controllers without the PLC Function.

EC-30 Trailer Controller



CONNECTOR

EC-30 ANTILOCK CONTROLLER

NOTE

The controller part number is found on the identification label attached to the edge of the housing and is lightly engraved on the top surface.



DIAGNOSTIC WINDOW

MC-30 TRAILER CONTROLLER CHANGEOVER	
Pc. No.	Service Pc. No.
5004357	800734
5004358	800735
5010172	801267
5010374	800734
5010375	800735
5010428	801166
5010431	801174
5010565	801267
5010566	801268
5010567	801229

MC-30 Serv. Pc. No.	Comments	Potential Replacement
800734	NO PLC	801267
800735		801268
801229	AXLE STEER	
801267	NO PLC	
801268		

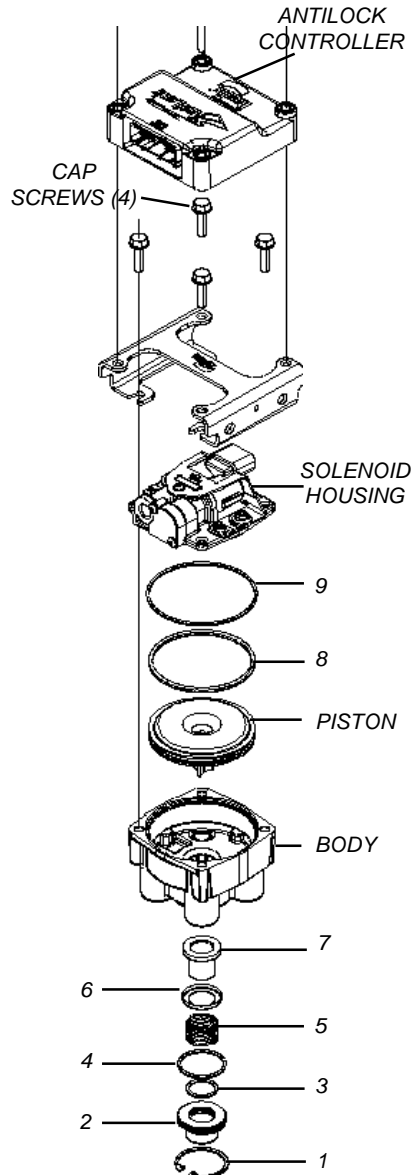

MAINTENANCE KIT 102802
CONTAINS THE FOLLOWING PARTS
KEYED TO THE ILLUSTRATION
ABOVE:

KEY NO.	QTY.	DESCRIPTION
1	1	RETAINING RING
2	1	EXH COVER CPL
3	1	O-RING
4	1	O-RING
5	1	VALVE SPRING
6	1	VALVE RETAINER
7	1	INL & EXH VALVE
8	1	O-RING

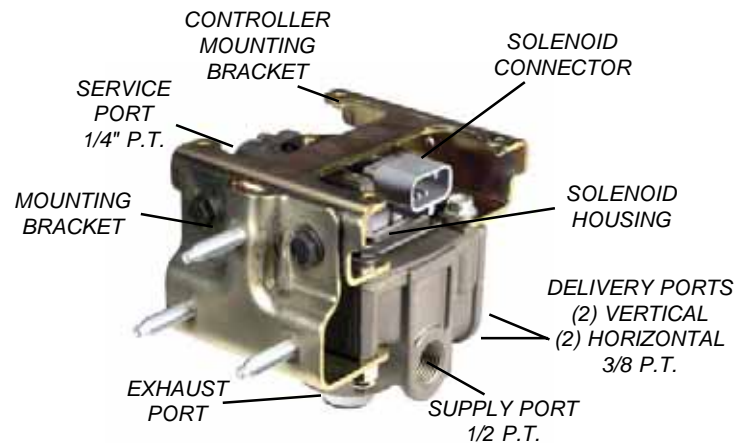

BRACKET MOUNT M-30T

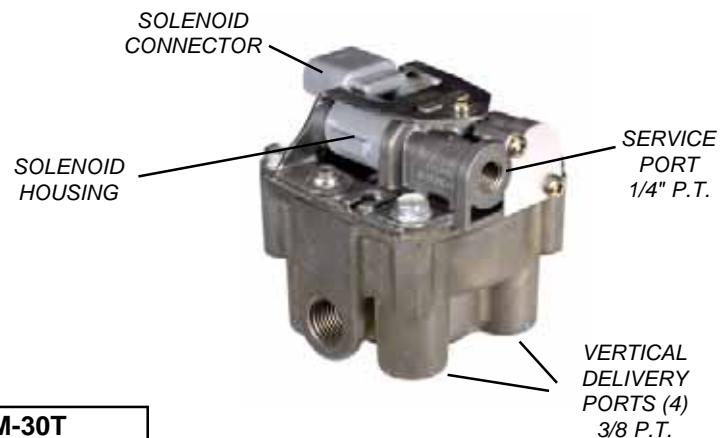

RESERVOIR MOUNT M-30T

M-30T CHANGEOVER	
Pc. No.	Service Pc. No.
5007658	800740
5007660	800741
5008271	800821
5009716	801134
5009718	801135
5009720	801136
5009724	801134
5009725	801135
5009726	801136

Service Pc. No.	Valve Style	Controller Mtg. Brkt.	Cover Rotatn.	Crack Press.
800741	RES. MT.	NO	90	4 psi
801134	RES. MT.	NO	90	5.5 psi
800740	RES. MT.	YES	90	4 psi
801135	RES. MT.	YES	90	5.5 psi
800821	BRKT. MT.	YES	90	4 psi
801136	BRKT. MT.	YES	90	5.5 psi

NOTE 1: Rotation orientation is: looking at the modulator exhaust port and rotating clockwise. Rotation is from the centerline of the control port to the centerline of the mounting bracket for bracket mounted M-30 and from the centerline of the supply port to the centerline of the control port for all other M-30s.

CATALOG 13-TLR-12

Antilock

Trailer MC-30 Pigtail Cable Assy.

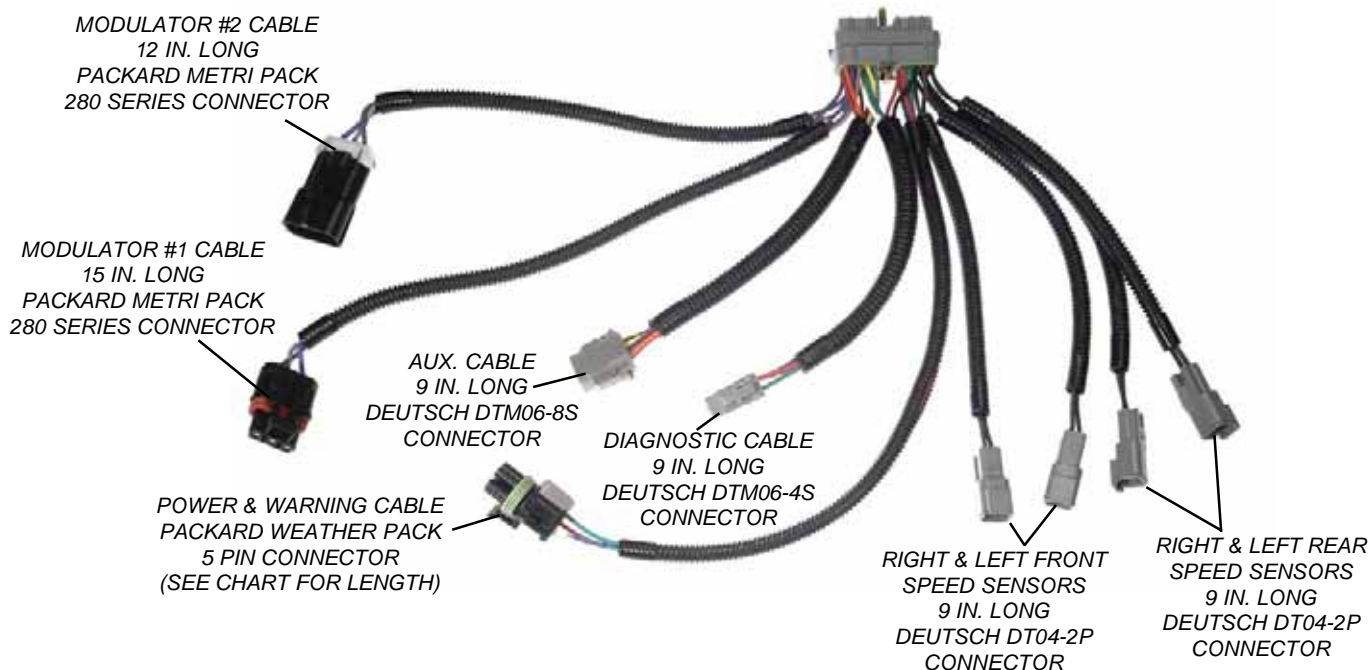

CHANGEOVER

O.E. Pc. No.	Service Pc. No.
5006240	800775
5007819	800776
5007820	800777
5007821	800778
5007822	800779
5007823	800780
5007824	800781
5007825	800782
5007826	800783
5007827	800784
5007828	800785
5007829	800786
5007830	800787
5008731	800956
5008732	800957
5008753	800935
5008754	800943
5008755	800951
5008756	800936
5008757	800937
5008758	800938
5008759	800939
5008760	800940
5008761	800941
5008762	800942
5008763	800944
5008764	800945
5008765	800946
5008766	800947
5008767	800948
5008768	800949
5008769	800950
5008770	800952

Service Pc. No.	Mod. Cable #2	Aux. Cable	Diag. Cable	Pwr./Warning Length	Right/Left Rear Sen.
800775	NO	NO	NO	1.4 FT.	NO
800776	NO	NO	NO	5.0 FT.	NO
800777	NO	NO	NO	10.0 FT.	NO
800778	NO	NO	NO	14.9 FT.	NO
800779	NO	NO	NO	19.5 FT.	NO
800780	NO	NO	YES	1.4 FT.	NO
800956	NO	NO	YES	5.0 FT.	NO
800957	NO	NO	YES	10.0 FT.	NO
800935	NO	NO	YES	14.9 FT.	NO
800936	NO	NO	YES	19.5 FT.	NO
800781	NO	YES	YES	1.4 FT.	NO
800782	YES	NO	NO	1.4 FT.	NO
800937	YES	NO	NO	5.0 FT.	NO
800938	YES	NO	NO	10.0 FT.	NO
800939	YES	NO	NO	14.9 FT.	NO
800940	YES	NO	NO	19.5 FT.	NO
800783	YES	NO	YES	1.4 FT.	NO
800941	YES	NO	YES	5.0 FT.	NO
800942	YES	NO	YES	10.0 FT.	NO
800943	YES	NO	YES	14.9 FT.	NO
800944	YES	NO	YES	19.5 FT.	NO
800784	YES	YES	YES	1.4 FT.	NO
800785	YES	NO	NO	1.4 FT.	YES
800945	YES	NO	NO	5.0 FT.	YES
800946	YES	NO	NO	10.0 FT.	YES
800947	YES	NO	NO	14.9 FT.	YES
800948	YES	NO	NO	19.5 FT.	YES
800786	YES	NO	YES	1.4 FT.	YES
800949	YES	NO	YES	5.0 FT.	YES
800950	YES	NO	YES	10.0 FT.	YES
800951	YES	NO	YES	14.9 FT.	YES
800952	YES	NO	YES	19.5 FT.	YES
800787	YES	YES	YES	1.4 FT.	YES



CHANGEOVER	
O. E. Pc. No.	Service Pc. No.
5007833	800790
5009193	801038
5009194	801039

Service Pc. No.	Cable Length
800790	10 Ft.
801038	6 Ft.
801039	7 Ft.

Basic Trailer ECUs and Hardware Components

**Basic Generation 5 Control Unit
With Power Line Carrier (PLC)**

Basic 2S-1M only 300340

**Basic Generation 5 Control Unit for Dollies
With Power Line Carrier (PLC)**

Basic 2S-1M only 300405

Limited Stock of Earlier Model may be Available

Basic Generation 4 Control Unit
Basic 2S-1M only 300253

*(Once limited stock on hand is depleted, replacement part is
300340)*

Basic Harnesses

2 Sensors, 1 valve, 3.3 ft. (1 m.) 300263

2 Sensors, 1 valve, 9.8 ft. (3 m.) 300264

2 Sensors, 1 valve, 15.1 ft. (4.6 m.) 300262

2 Sensors, 1 valve, 19.7 ft. (6.0 m.) 300265

2 Sensors, 1 valve, 24.6 ft. (7.5 m.) 300298

Diagnostic Extension Harness

8 ft. (2.4 m.) 300281

Replacement Cover 300271

Replacement Bracket 300270

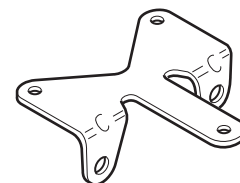
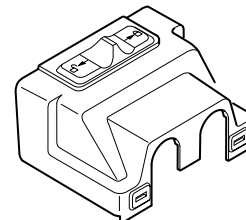
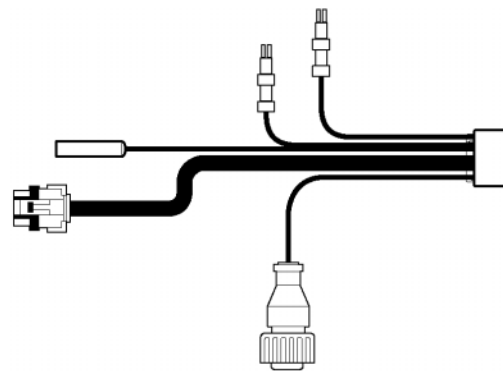
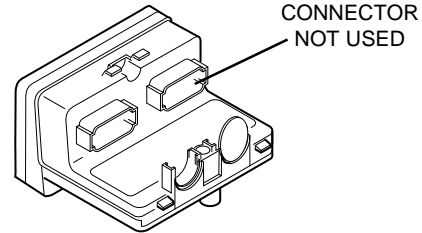
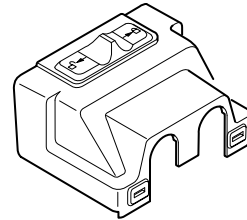

Basic Trailer ABS

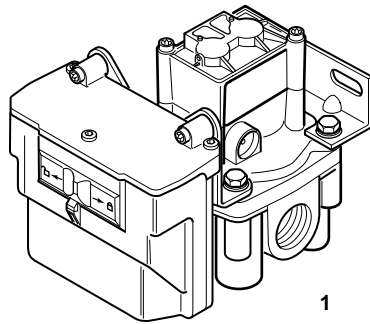

1

(1) Relay Valve with Gen 5 ECU (300340), (PLC), 4.0 PSIG Crack Pressure, 4 Delivery Ports.
Frame-mounted with Bracket 300358

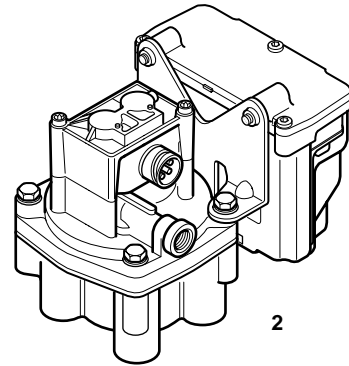

2

(2) Relay Valve with Gen 5 ECU (300340), (PLC), 4.0 PSIG Crack Pressure, 4 Delivery Ports.
3/4 NPT Tank-mounted 300360

Limited Stock of Earlier Model may be Available

Relay Valve with Gen 4 ECU (300253), 4.0 PSIG Crack Pressure, 4 Delivery Ports. Frame-mounted with Bracket 300267
(Once limited stock on hand is depleted, replacement part is 300358)

Limited Stock of Earlier Model may be Available

Relay Valve with Gen 4 ECU (300253), 4.0 PSIG Crack Pressure, 4 Delivery Ports.
3/4 NPT Tank-mounted 300269
(Once limited stock on hand is depleted, replacement part is 300360)

Limited Stock of Earlier, Two Delivery Port Models, may be Available

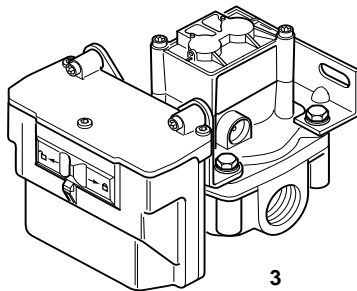

3

Trailer ABS 2 Delivery Port Models

(3) Relay Valve with Gen 5 ECU (300340), (PLC), 4.0 PSIG Crack Pressure. Frame-mounted with Bracket 300357
(Once limited stock on hand is depleted, replacement part is 300358, 2 pipe plugs required.)
(3) Relay Valve with Gen 4 ECU (300253) 4.0 PSIG Crack Pressure. Frame-mounted with Bracket 300266
(Once limited stock on hand is depleted, replacement part is 300357)
(3) Dolly Relay Valve with Gen 4 ECU (300253) 4.0 PSIG Crack Pressure. Frame-mounted with Bracket 300406

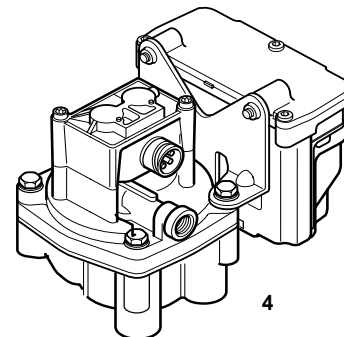

4

(4) Relay Valve with Gen 5 ECU (300340), (PLC), 4.0 PSIG Crack Pressure.
3/4 NPT Tank-mounted 300359
(Once limited stock on hand is depleted, replacement part is 300360, 2 pipe plugs required.)
(4) Relay Valve with Gen 4 ECU (300253), 4.0 PSIG Crack Pressure.
3/4 NPT Tank-mounted 300268
(Once limited stock on hand is depleted, replacement part is 300359)

Note: Relay valve or modulator valves may be serviced independently.

Standard Trailer ECUs

Standard Generation 5 Control Unit With Power Line Carrier (PLC)

Standard 4S-2M, 2S-2M, 2S-1M, Side Control . . . 300341

Limited Stock of Earlier Model may be Available

Standard Generation 4 Control Unit
Standard 4S-2M, 2S-2M, 2S-1M,
Side Control 300183

*(Once limited stock on hand is depleted, replacement part is
300341)*

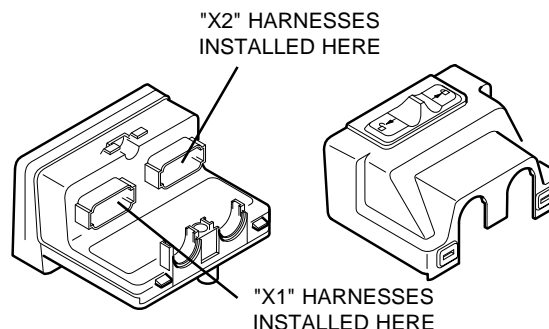

Standard Trailer ABS

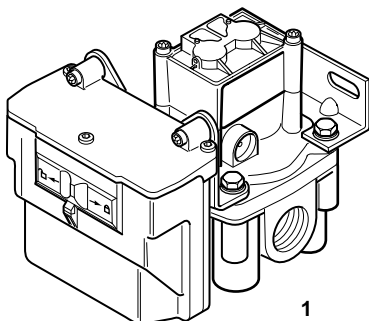

(1) Relay Valve with Gen 5 ECU (300341), (PLC), 4.0
PSIG Crack Pressure, 4 Delivery Ports. Frame-
mounted with Bracket 300362

Changeover:

Previous Gen 4 version 300217 is replaced by 300362.

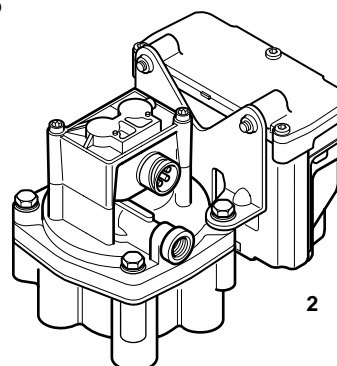

(2) Relay Valve with Gen 5 ECU (300341), (PLC), 4.0
PSIG Crack Pressure, 4 Delivery Ports.
3/4 NPT Tank-mounted 300364

Changeover:

Previous Gen 4 version 300213 is replaced by 300364.

Limited Stock of Earlier, Two Delivery Port Models, may be Available

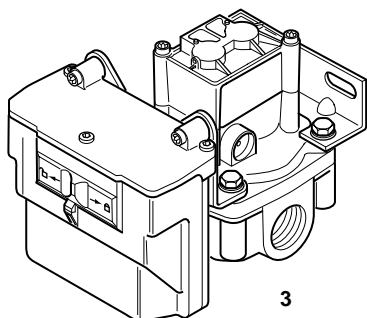

Two Delivery Port Models

(3) Relay Valve with Gen 5 ECU (300341)
(PLC), 4.0 PSIG Crack Pressure.
Frame-mounted with Bracket 300361
(Once limited stock on hand is depleted,
replacement part is 300362, 2 pipe plugs required.)

Changeover:

Previous Gen 4 version 300216 is replaced by 300361.

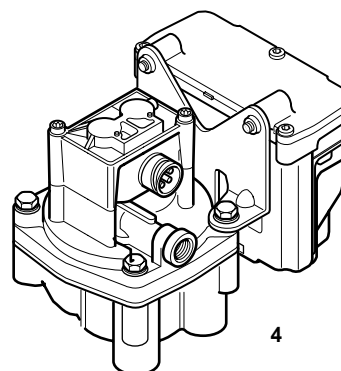

(4) Relay Valve with Gen 5 ECU (300341)
(PLC), 4.0 PSIG Crack Pressure.
3/4 NPT Tank-mounted 300363
(Once limited stock on hand is depleted,
replacement part is 300364, 2 pipe plugs required.)

Changeover:

Previous Gen 4 version 300212 is replaced by 300363.

Note: Relay valve or modulator valves may be serviced independently.

Standard Trailer Hardware Components

See opposite page for X1 and X2 Harness installation.

X1 - Style A, 1 valve

3.3 ft. (1.0 m.)	300232
9.8 ft. (3.0 m.)	300244
15.1 ft. (4.6 m.)	300220
19.7 ft. (6.0 m.)	300245
24.6 ft. (7.5 m.)	300297

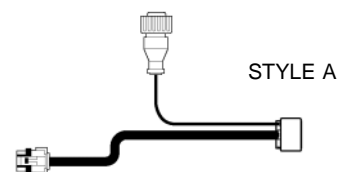

X1 - Style B, 2 valves [all have one valve harness of 1.65 ft (0.5 m.)]

3.3 ft. (1.0 m.), second valve harness 3.3 ft. (1.0 m.)	300231
3.3 ft. (1.0 m.), second valve harness 21.0 ft. (6.4 m.)	300348
3.3 ft. (1.0 m.), second valve harness 38.9 ft. (11.9 m.)	300334
9.8 ft. (3.0 m.), second valve harness 3.3 ft. (1.0 m.)	300246
9.8 ft. (3.0 m.), second valve harness 21.0 ft. (6.4 m.)	300347
9.8 ft. (3.0 m.), second valve harness 38.9 ft. (11.9 m.)	300333
15.1 ft. (4.6 m.), second valve harness 3.3 ft. (1.0 m.)	300221
15.1 ft. (4.6 m.), second valve harness 21.0 ft. (6.4 m.)	300349
15.1 ft. (4.6 m.), second valve harness 38.9 ft. (11.9 m.)	300335
19.7 ft. (6.0 m.), second valve harness 3.3 ft. (1.0 m.)	300247
19.7 ft. (6.0 m.), second valve harness 21.0 ft. (6.4 m.)	300346
19.7 ft. (6.0 m.), second valve harness 38.9 ft. (11.9 m.)	300332

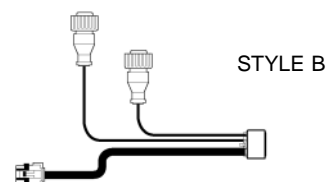

X2 - Style C, 2 Sensor Extension Harness, Full Diagnostics

5.9 ft. (1.8 m.) Sensor Harnesses, 9.8 ft. (3.0 m.) Diagnostic Harness	300218
7.9 ft. (2.4 m.) Sensor Harnesses, 9.8 ft. (3.0 m.) Diagnostic Harness	300254

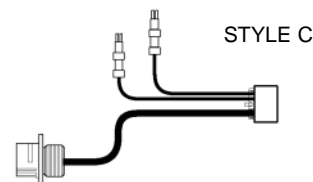

X2 - Style D, 4 Sensor Extension Harness, Full Diagnostics

Two 5.9 ft. (1.8 m.) and two 7.9 ft. (2.4 m.) Sensor Harnesses, 9.8 ft. (3.0 m.) Diagnostic Harness	300219
0.7 ft. (0.2 m.) Sensor Harnesses, 9.8 ft. (3.0 m.) Diagnostic Harness	300374
7.9 ft. (2.4 m.) Sensor Harnesses, 9.8 ft. (3.0 m.) Diagnostic Harness	300256

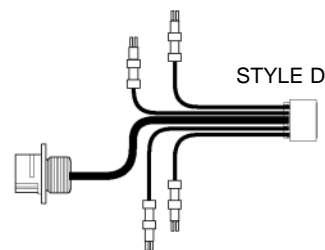

X2 - Style E, 2 Sensor Extension Harness, Blink-code Diagnostics

5.9 ft. (1.8 m.) Sensor Harnesses, 9.8 ft. (3.0 m.) Diagnostic Harness	300233
5.9 ft. (1.8 m.) Sensor Harnesses, 5.9 ft. (1.8 m.) Diagnostic Harness	300282
8.0 ft. (2.4 m.) Sensor Harnesses, 5.9 ft. (1.8 m.) Diagnostic Harness	300255

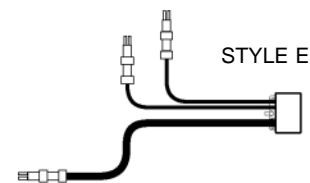

X2 - Style F, 4 Sensor Extension Harness, Blink-code Diagnostics

Two 6.0 ft. (1.8 m.) and two 8.0 ft. (2.4 m.) Sensor Harnesses, 10.0 ft. (3.0 m.) Diagnostic Harness	5011721
Four 8.0 ft. (2.4 m.) Sensor Harnesses, 10.0 ft. (3.0 m.) Diagnostic Harness	5011722

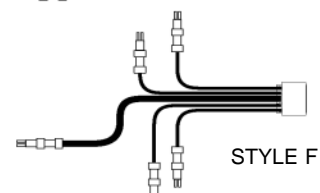

X2 - Style G, Power Harness

Power Harness, with Warning Light Bullet 39.6 ft. (12.0 m.)	300225
Power Harness, with Warning Light Bullet 49.2 ft. (15.0 m.)	300226
Power Harness, with Warning Light Bullet 65.6 ft. (20.0 m.)	300227



**Trailer Modulator Relay Valves (Without ECU). Used with Gen 4 & 5 ECUs.
Twist-Lock Connectors**

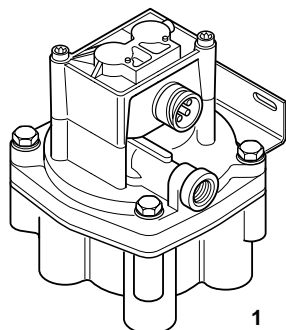

1

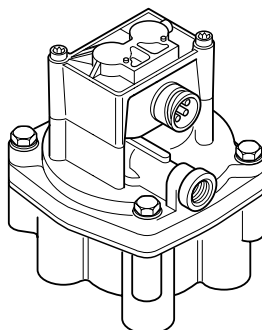

2

Note: Where 2 port valve is required, unused ports may be plugged.

Trailer Relay Valves

Twist-Lock Connectors, 4 PSIG Crack Pressure

(1) 4 Delivery ports, frame-mounted with bracket, for use with 4 type-30 chambers. 300215

(2) 4 Delivery ports, 3/4" NPT tank-mounted, for use with 4 type-30 chambers. 300193

Limited Stock of Earlier, Two Delivery Port Models, may be Available

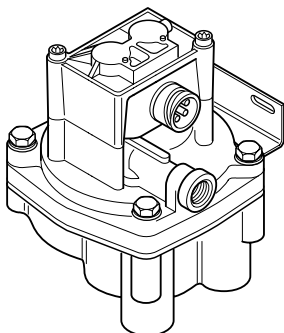

3

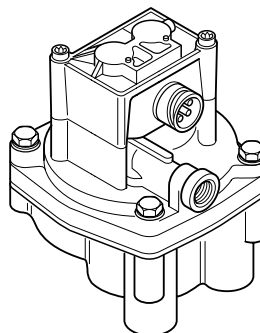

4

Trailer Relay Valves

Twist-Lock Connectors, 4 PSIG Crack Pressure

(3) 2 Delivery ports, frame-mounted with bracket, for use with 2 type-30 chambers. 300214
(Once limited stock on hand is depleted, replacement part is 300215, 2 pipe plugs required.)

(4) 2 Delivery ports, 3/4" NPT tank-mounted, for use with 2 type-30 chambers. 300192
(Once limited stock on hand is depleted, replacement part is 300193, 2 pipe plugs required.)

Note: Relay valve or modulator valves may be serviced independently.

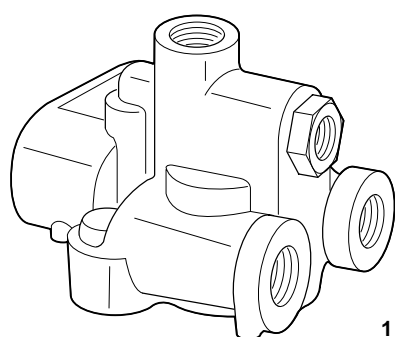

1

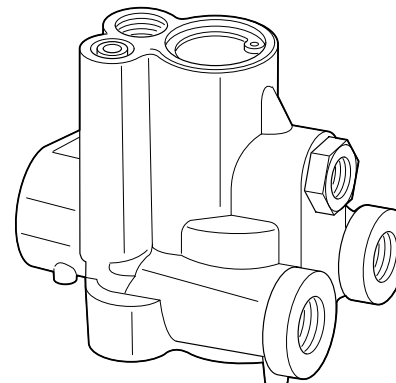

2

Spring Brake Control Valves

(1) TEV (Spring Brake Priority) 300251

(2) STEV (Service Brake Priority) 300252

Trailer Diagnostic Labels

Bendix Trailer ABS

Part 1-Configuration	Part 2-Fault Status
1 2s-1m	1 System OK
2 2s-2m	2 Sensor A Fault**
3 4s-2m Side Control	3 Sensor B Fault**
4 4s-2m Auto Control	4 Sensor C Fault**
	5 Sensor D Fault**
	6 Valve A Fault
	9 Valve B Fault
	11-14 Internal ECU
	12 Low Voltage

Notes:
* 4s-2m Auto Control requires unique part No. ECU
** Long Blink on final pulse indicates air gap fault
*** Vehicle must be driven to turn warning light off after sensor fault

Example:
A 1-3 code indicates a 2s-1m system with a fault associated with sensor B

Pause

FULL FEATURE SYSTEMS

BASIC SYSTEM

Trailer Harness
User supplied Grounding Jumper

To Read Fault Codes:

1. Apply power to trailer (key switch or brake pedal).
2. Short pins "A" and "E" on trailer diagnostic port or apply ground at the bullet connector for at least 2 seconds and release.
3. Observe trailer ABS warning light and record blink code.
4. Refer to Blink code chart for description.

To Clear Fault Codes:

1. Remove power.
2. Short pins "A" and "E" on trailer diagnostic port or apply ground at the bullet connector.
3. Apply power to trailer for at least 2 seconds. (key switch or brake pedal).
4. Remove the short or ground from step 2.
5. Read fault codes and verify that faults are cleared***.

For assistance: 1-800-AIR-BRAKE

Trailer Diagnostic Label - Gen 4

Formerly 300275 5011261

Bendix Trailer ABS

Code	Description
1	System OK
2	Sensor A Fault**
3	Sensor B Fault**
4	Sensor C Fault**
5	Sensor D Fault**
6	Valve A Fault
9	Valve B Fault
11-14	Internal ECU
12	Low Voltage

Notes:
* 4s-2m Auto Control requires unique part No. ECU
** Long Blink on final pulse indicates air gap fault
*** Vehicle must be driven to turn warning light off after sensor fault

Example:
A 1-3 code indicates a 2s-1m system with a fault associated with sensor B

Pause

STANDARD SYSTEM

BASIC SYSTEM

Trailer Harness
User supplied Grounding Jumper

To Read Fault Codes:

1. Apply power to trailer (key switch or brake pedal).
2. Jump pins "A" and "E" on the trailer diagnostic port or apply ground at the bullet connector for at least 2 seconds and release.
3. Observe trailer ABS warning light and record blink code.
4. Refer to blink code chart for description.

To Clear Fault Codes:

1. Remove power.
2. Jump pins "A" and "E" on the trailer diagnostic port or apply ground at the bullet connector.
3. Apply power to trailer (key switch or brake pedal).
4. Remove the jumper or ground from step 2 at least 2 seconds after applying power.
5. Read fault codes and verify that faults are cleared.

For assistance: 1-800-AIR-BRAKE

Trailer Diagnostic Label - Gen 5

Formerly 300381 5011262

SENSOR CONNECTION

HARNESS CONNECTION



Wheel End Speed Sensor Extension Harnesses

3.3 ft. (1.0 m.)	300257
6.6 ft. (2.0 m.)	300258
9.8 ft. (3.0 m.)	300259
13.2 ft. (4.0 m.)	300260

SENSOR CONNECTION

ECU CONNECTION



**Wheel End Speed Sensor Extension Harnesses
with One End Unterminated**

6.6 ft. (2.0 m.)	300090
9.8 ft. (3.0 m.)	300091
16.4 ft. (5.0 m.)	300092
26.3 ft. (8.0 m.)	300093
32.8 ft. (10.0 m.)	300094
39.4 ft. (12.0 m.)	300095

VALVE CONNECTION

ECU CONNECTION



**Threaded Modulator Valve Extension Harnesses
with One End Unterminated**

3.3 ft. (1.0 m.)	300113
9.8 ft. (3.0 m.)	300096
13.1 ft. (4.0 m.)	300097
19.7 ft. (6.0 m.)	300098
25.1 ft. (7.6 m.)	300384
29.5 ft. (9.0 m.)	300099
39.4 ft. (12.0 m.)	300100
49.2 ft. (15.0 m.)	300101

VALVE CONNECTION

ECU CONNECTION



**Bayonet Modulator Valve Extension Harnesses with
One End Unterminated**

25.1 ft. (7.6 m.)	300385
-------------------	--------

