

The ET-S2 is an engine compartment bulkhead mounted electronic treadle. On electronically controlled diesel engines, the ET-S2 fulfills the same function as a conventional mechanical throttle. However, rather than transmitting a mechanical force to the engine governor, the ET-S2 controls engine speed by supplying a variable electrical voltage to the engine's electronic controller.

The main components of the ET-S2 are: a mounting plate, suspended treadle, potentiometer (variable resistor), actuator body and base. The selected potentiometer, chosen for a specific engine application, provides the electrical link to the engine control system.

For Service Data and Maintenance Information, see SD-15-4111.

WEIGHT approx. 2.9 lbs.

VRMS No. is 44-007-047.

Device Code for the Caterpillar version is 4115.

Device Code for the Cummins version is 4116.

Device Code for the Detroit Diesel Corp. version is 4117.

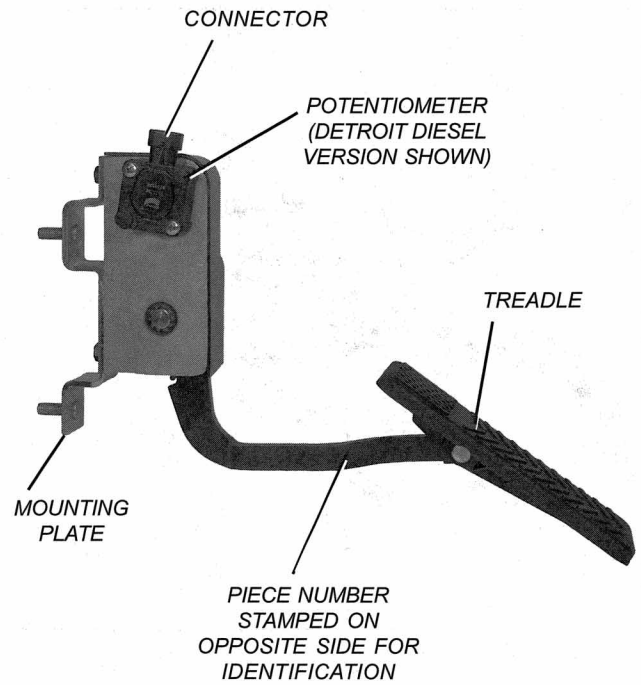

O. E. Piece Number (Use for Identification)	Service Replacement Part	Treadle & Spring Kit	Potentiometer Replacement Kit
5005131	800606	5006085	5002356 (Cummins)
5005133	800607	5006085	5006086 (DDC)
5005135	800608	5006085	5002357 (Caterpillar)

SEE PAGE 15-B-5 FOR RETROFIT KITS

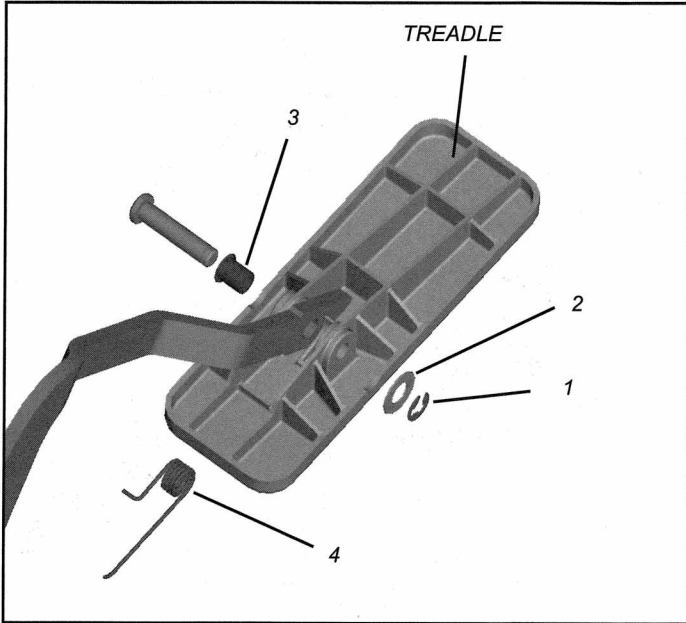

TREADLE KIT - SERVICES ALL ASSEMBLIES

KEY	ITEM	QTY
1	RETAINING RING	1
2	NYLON WASHER	1
3	NYLINER BEARING	1
4	TREADLE SPRING	1

POTENTIOMETER KITS

KIT 5002356
Cummins
Potentiometer/Switch

6 PIN CONNECTOR

Number shown here is not a piece no. - DO NOT attempt to use for ordering service replacement

[KIT INCLUDES TWO #10 CAP SCREWS]

KIT 5002357
Caterpillar Position Sensor

3 PIN CONNECTOR

WIRE HARNESS ATTACHED

Number shown here is not a piece no. - DO NOT attempt to use for ordering service replacement

[KIT INCLUDES TWO #10 CAP SCREWS]

KIT 5006086
DDC Potentiometer

3 PIN CONNECTOR

Number shown here is not a piece no. - DO NOT attempt to use for ordering service replacement

[KIT INCLUDES TWO #10 CAP SCREWS]

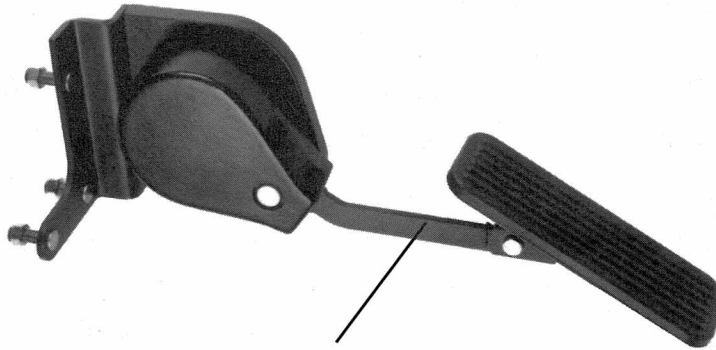

ET-S IDENTIFICATION
NUMBER STAMPED HERE

Retrofit Kits			
ET-S (obsolete)		ET-S2 Retrofit Kit	Engine
5001649	(5001550*)	5006222	Cummins
5001650	(5001551*)	5006224	Caterpillar
5001651	(5001552*)	5006223	DDC

*These identification numbers are found on early release models of the ET-S.

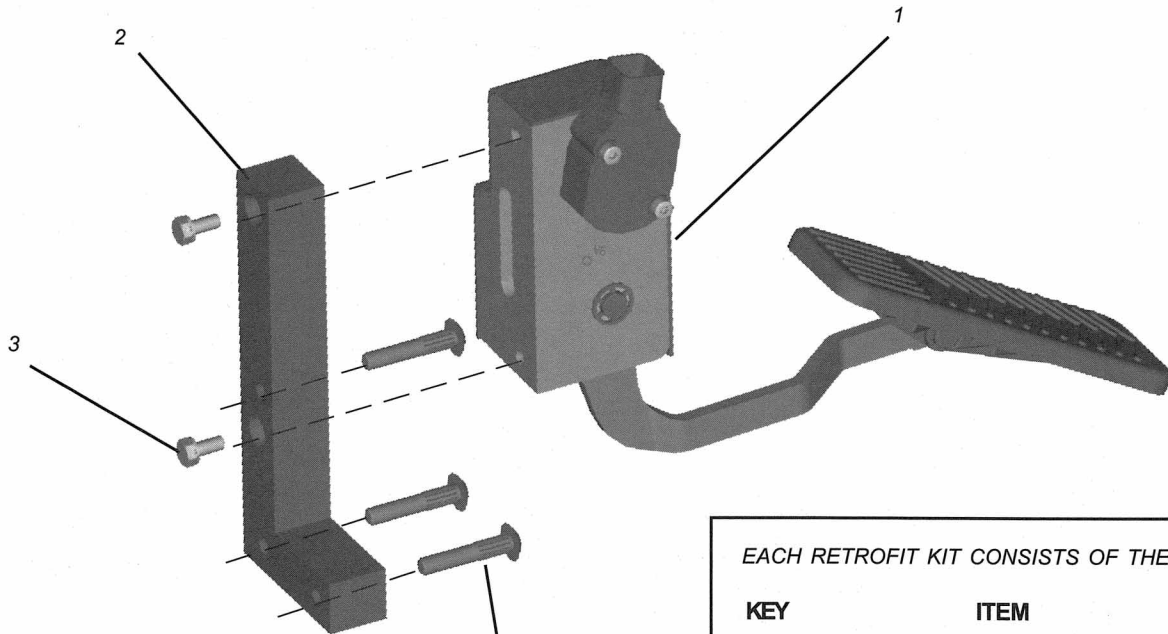

STUDS PRE-ASSEMBLED
IN SPACER BLOCK (2)
*LOCKWASHERS (4) AND NUTS (5)
NOT SHOWN

EACH RETROFIT KIT CONSISTS OF THE FOLLOWING		
KEY	ITEM	QTY
1	ET-S2 ASSEMBLY	1
2	SPACER BLOCK & STUDS	1
3	1/4" MACHINE SCREW	2
4*	LOCKWASHERS	3
5*	NUT	3