

# TRACTOR PROTECTION VALVE

TP-3DC

CATALOG  
03-M-04

The TP-3DC integrates tractor protection and double check valve functions. It also has an integral single check valve that prevents trapping of air in the trailer service line. This prevents service and spring brake compounding, and it avoids a trailer roll away situation if the trailer is parked with the air applied.

A stoplight switch port allows direct stoplight installation, and the auxiliary supply port, when connected to the BP-R1 control port, eliminates a tee in the tractor supply line. Also, a QR-L can be factory installed in the trailer service and/or supply port to meet timing requirements.

Weight: 1.5 lbs.

Material: Die-cast aluminum

Operating pressure: 150 psi maximum

Operating temperature: -40° to 200° F

Service Data Sheet: SD-03-3656

VMRS No.: 13-010-016

Maintenance Kit: 5000073

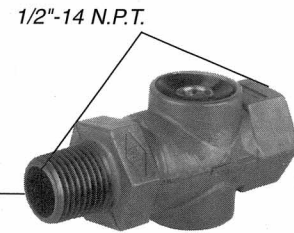
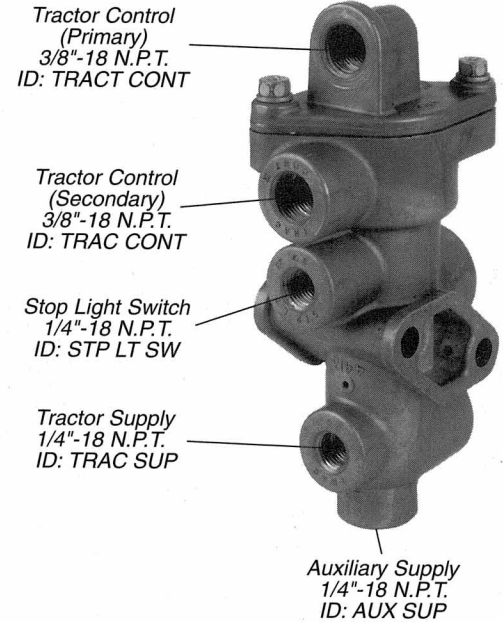
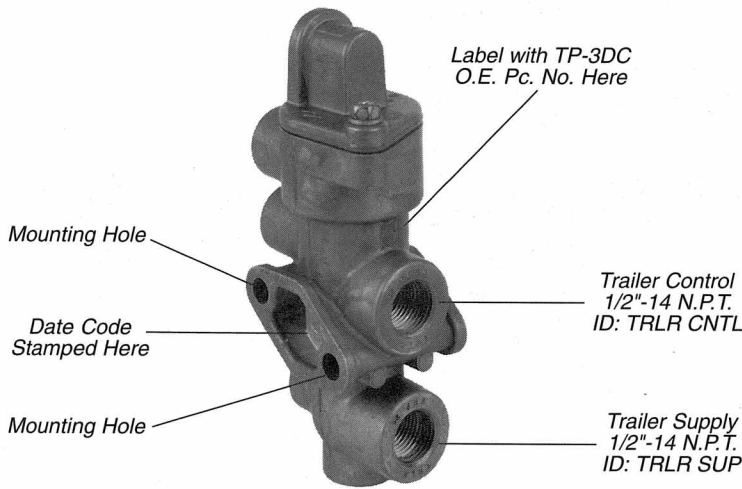

### QR-L

Factory installed on some TP-3DC models. Service replacement: 065707. For more information on the QR-L, see SD-03-906 and Catalog 03-A-2D.

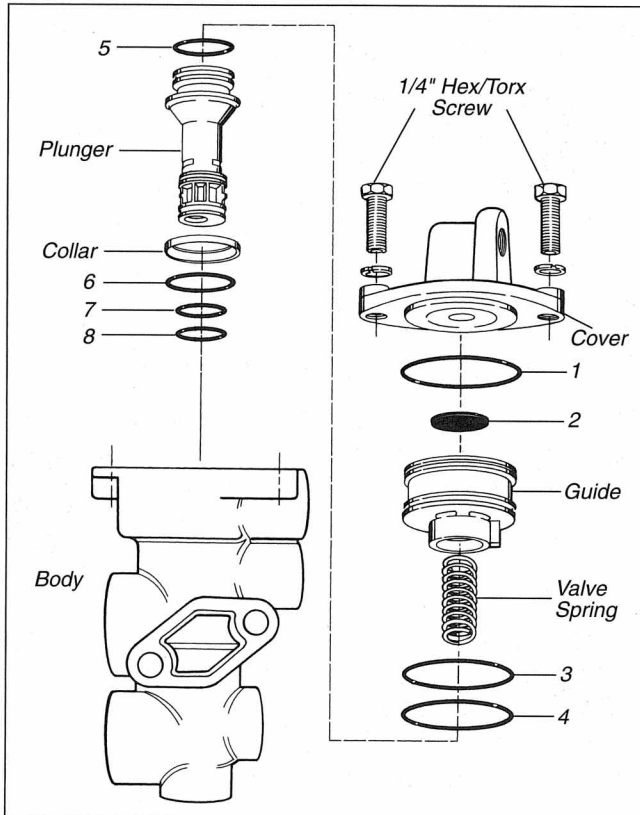

### Maintenance Kit 5000073 Contents:

KEY NO.	QTY.	DESCRIPTION
1	1	O-ring
2	1	Diaphragm
3	1	O-ring
4	1	O-ring
5	1	O-ring
6	1	O-ring
7	1	O-ring
8	1	O-ring

O.E. PIECE	COMMENTS
109790	No QR-L
109791	QR-L Located in Trailer Supply Port
109792	QR-L Located in Trailer Supply and Control Port
5001186	QR-L Located in Trailer Control Port

SVC. PIECE NO.	REMAN PIECE NO.
065706*	5001455*

\*Note: Service and Reman Assy. do not include QR-L Assy.